

MARINE
EQUIPMENT
GUIDE | 08
09

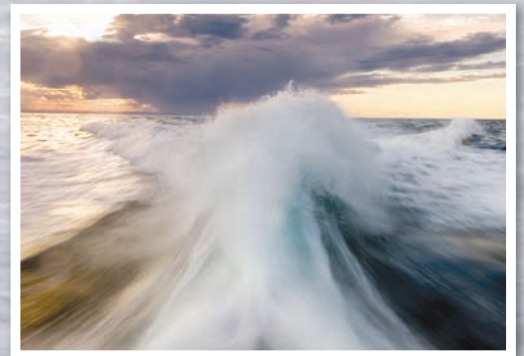



Easy Anchoring Starts with a Lewmar Windlass.

Whether you're a power cruiser, fisherman or sailor, Lewmar has a windlass designed to fit your exact needs. Each one is crafted with durability, convenience and affordability in mind. And both our vertical and horizontal designs are sleek and attractive to complement your boat. Which explains why boat builders continue to put Lewmar Windlasses on theirs.

Windlass Selection Guide

Model	Size	Boat Length Overall													
	m ft	6 20	9.2 30	12.2 40	15.2 50	18.3 60	21.3 70	24.4 80	27.4 90	30.5 100	33.5 110	36.6 120	39.7 130	42.7 140	
Pro-Sport 550															
Pro-Series 700															
Pro-Series 1000															
Pro-Fish 700															
Pro-Fish 1000															
H2															
H3															
V700															
V1															
V2															
V3															
V4															
V5															
C3															
C4															
C5															
V4000															
V6000															
3000															
3500															
4000															
5000															
6000															
8000															

Choosing the right windlass for your boat.

In order to select the correct windlass for your boat, three questions should be answered:



1. What size windlass would best suit my boat?

Use our windlass selection chart found on page 2 to determine the general size of windlass to be fitted to your boat by using length and displacement. For example, if you have a 10m (33 ft) boat, typically a 270kg (600 lb) pull windlass would be selected. The rule to crosscheck your windlass selection is to add the total weight of the chain and the weight of the anchor together. Rope is very light and does not affect the actual lifting performance of the windlass, but can be factored in. For safe cruising in all types of conditions and sea areas, Lewmar recommends that you multiply the total weight of your anchor and chain by 4. This number should be less than the maximum pull of the windlass you have selected. Should your findings be at or more than the maximum pull, select the next largest windlass. The windlass does not stow the anchor rode in the locker. Gravity stows the rode in the locker. There must be a free and clear area under the hawse pipe for the incoming rode to lie; if not the rode will jam. Your windlass is a retrieval device; the windlass retrieves the anchor and rode. A windlass is not a high load bearing device. When at anchor your rode should be secured to a cleat or other mooring point on the bow.

2. How long is the anchor rode I wish to use, and will the windlass put the entire rode into my locker?

Begin by examining the depth of the anchor locker to determine the fall that is available. The fall is the vertical distance between the top of the anchor locker and the top of the anchor rode when the entire rode is completely stored inside. This measurement is important in determining whether your boat will be best suited for a vertical or horizontal windlass. Do not stow the rode inside the anchor locker; gravity stows the rode. Anchor windlasses must be operated; you must know how much rode will fit into your locker by gravity. There has to be a free and clear area under the hawse pipe for the incoming rode. Otherwise you will have to comb the rode back, keeping a clear and free space under the hawse pipe while retrieving the anchor.

3. How much pulling power should my windlass have?

Having selected a vertical or horizontal windlass and determined the size required using the chart on page 2, you can crosscheck by using the following formula:

$$\begin{array}{l} \text{Total weight of ground} \\ \text{tackle (anchor} \\ \text{and rode)} \text{ ____ x 4} \end{array} = \begin{array}{l} \text{Pulling power} \\ \text{required by} \\ \text{the windlass} \end{array}$$

Safety at anchor:

Never allow the windlass to hold the boat while at anchor. Always tie off to a strong point other than the windlass.

Safety while underway:

Always tie off the anchor to a safety device to secure the anchor in case of accidental deployment. It is good practice to isolate the circuit breaker/isolator switch while underway.

Horizontal Windlasses

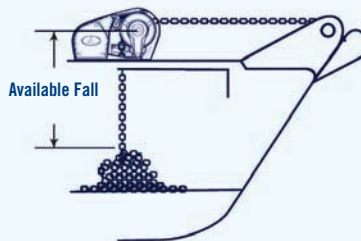

The key features of Horizontal Windlasses are:

- Most of the windlass unit is on the deck
- Easy installation
- Good for boats with small anchor lockers
- Anchor rode enters the gypsy and makes 90° turn and feeds into the anchor locker
- Minimum fall of 304mm (12") is recommended in order to have enough gravity to pull the rode down into the locker

Vertical Windlass



The key features of Vertical Windlasses are:

- More of the unit is hidden below deck
- Suitable for large anchor lockers
- Anchor rode makes a 180° wrap around the gypsy and a 90° turn into the anchor locker
- Minimum of 406mm (18") fall is recommended in order to have enough gravity to pull the rode down into the locker



Horizontal Windlass

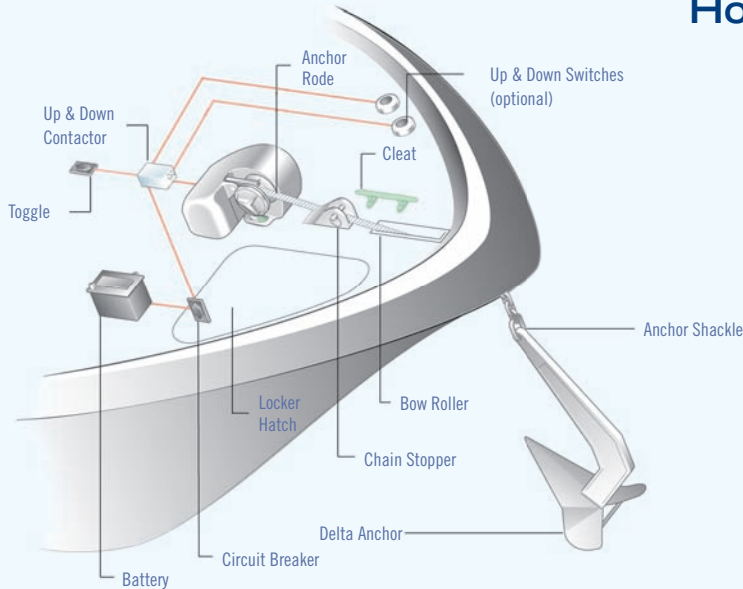

Vertical Windlass

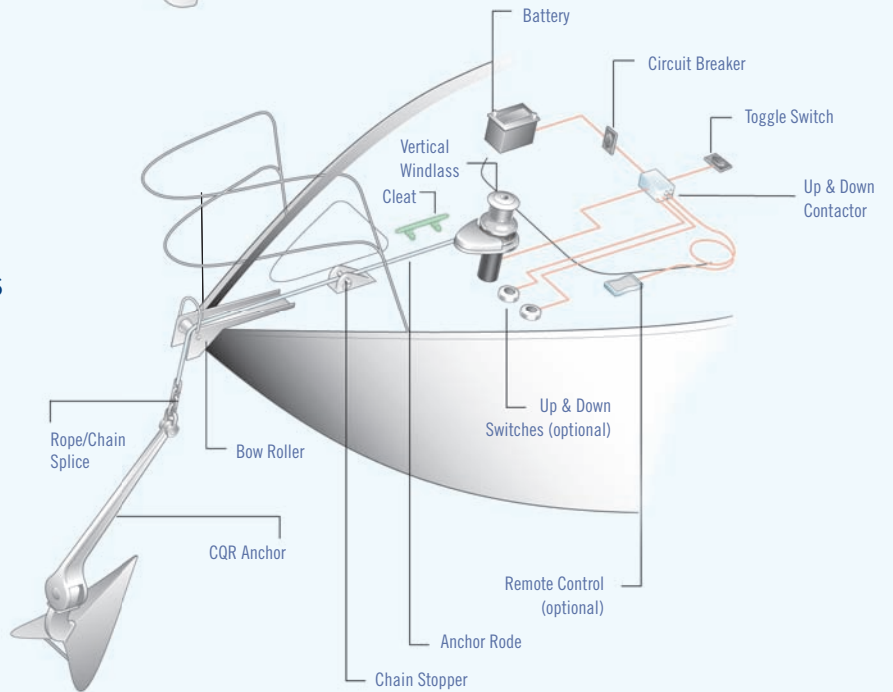

Please see your owners manual for complete installations diagrams.

Windlass & Anchor Operation Safety Tips

ALWAYS

- Always tie off anchor rode while at anchor
- Always secure anchor rode/anchor when under way
- Always look before deploying your anchor
- Always motor up to anchor while retrieving
- Always shut off circuit breaker when working on windlass
- Always shut off circuit breaker when windlass is not in use

NEVER

- Never use your windlass to pull or tow boat
- Never use your windlass to lift a person
- Never stick fingers in or around gypsy while operating

MUST

- Keep all loose clothing and hair away from windlass when operating

NEW Pro-Sport

Lewmar's new Pro-Sport rope/chain windlass is designed as an economical package for rope and chain applications, without compromise to quality or performance. Pro-Sport is designed around a highly efficient spur gearbox, using smaller, more powerful permanent magnet motors. The unit has manual freefall and two gypsy sizes to choose from. It's DIY-ready and easy to install. Its rugged aluminum center case and durable composite side covers make Pro-Sport the perfect choice. Complete with push-button control, anchoring has never been easier. A demonstration of Lewmar's commitment to provide stylish, affordable, quality products for boats from 6m-9m (20-30ft).



Features

- Powerful motor providing superior line speed
- Low power consumption / current draw
- Dual direction powered operation
- Manual freefall
- Choice of two gypsy sizes, 6mm & 7mm (1/4") chain
- Maximum pulling power: 225kg (500 lbs)
- Convenient above-deck installation
- Comprehensive range of switch gear options available
- 3-year warranty

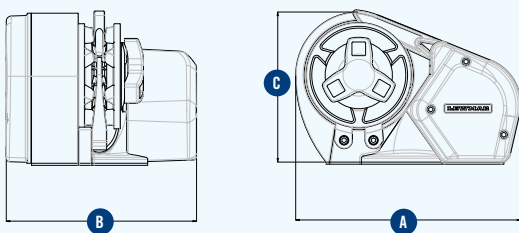
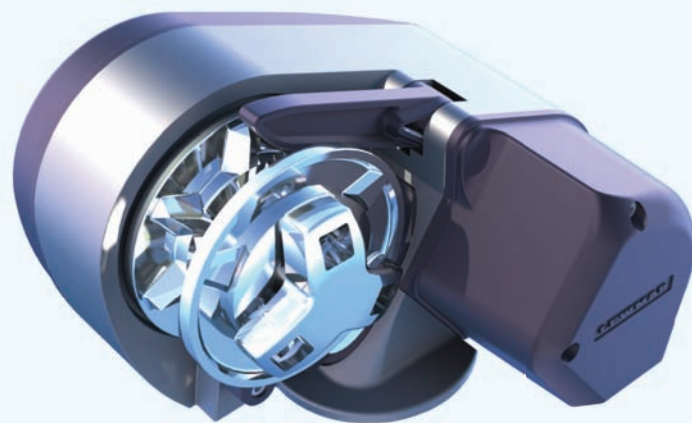

Pro-Sport Dimensions

Model	A		B		C	
	mm	in	mm	in	mm	in
Pro-Sport 550	214	8 7/16	181	7 1/8	143	5 5/8

* If fitting under deck, please allow for at least 10mm / 1/2" control arm travel when unit is running.

Pro-Sport 550 Specifications

Part Number	Description	Gypsy No.	Motor Power Option	Typical Power Watts	Typical Max Pull		Maximum Line Speed		Working Load		Normal Current Draw	Typical Line Speed/min		Weight		Circuit Breaker
					kg	lb	m	ft	kg	lb		m	ft	kg	lb	
6656811196-303	Pro-Sport 550 G 12V 6mm Kit*	502	12 V	150 W	225	550	30	98	50	110	20A	19	62	8	17.6	25A
6656811197-303	Pro-Sport 550 G 12V 7mm / 1/4" Kit*	503	12 V	150 W	225	550	30	98	50	110	20A	19	62	8	17.6	25A

* Kits include: windlass, base gasket seal, fast mounting studs, installation wrench, toggle switch and circuit breaker.

Note: Part Number 6656811196-303 is not available in the USA

Pro-Sport Gypsy Specifications

Gypsy Number	Chain Description	Rope Description		
		mm	in	
502	6mm DIN766	12mm	1/2	3-strand and 8-plait
503	1/4" G4, 1/4" BBB, 7mm DIN 766	12mm	1/2	3-strand and 8-plait

For cable specifications refer to p. 24

Pro-Series



Praised by professionals worldwide, the horizontal Pro-Series is a shining example of Lewmar's commitment to provide quality products for boats from 6m-13m (20-42ft). It's DIY-ready, easy to install and housed in 100% 316 stainless steel, making it well protected and durable. And with push-button control and a built-in manual emergency recovery system, anchoring has never been easier.



Optional Pro-Fish (Freefall Kit) Now Available

Part Number: 66000616

Pro-Series built after October 2006 with serial number
561***** or 571***** will accept upgrade kit.

Features

- Manual freefall
- Powerful motor providing fast line speed
- Manual emergency recovery equipped – all you need is a common 1/2" socket wrench
- Strong 100% 316 stainless steel, including control arm and stripper
- Maximum pulling power: 320kg (700 lbs) for the 700 and 454kg (1,000 lbs) for the 1000
- Convenient above-deck installation
- 5-year warranty
- Automatic freefall kit available (Pro-Series built after Oct. 2006 with serial # 561 and #571 will accept Pro-Fish freefall kit)



Pro-Series Windlass Specifications

Part Number	Description	Gypsy No.	Motor Power Option	Typical Power Watts	Typical Max Pull		Maximum Line Speed		Working Load		Normal Current Draw	Typical Line Speed/min		Weight		Circuit Breaker
					kg	lb	m	ft	kg	lb		m	ft	kg	lb	
6656011196-301	Pro-Series 700 G 12V 6mm Kit*	502	12 V	500 W	320	700	32	105	79	175	35A	27	88	8.5	19	50A
6656011197-301	Pro-Series 700 G 12V 7mm Kit*	503	12 V	500 W	320	700	32	105	79	175	35A	27	88	8.5	19	50A
6657011196-102	Pro-Series 1000 G 12V 6mm Kit*	502	12 V	700 W	454	1000	32	105	113	250	50A	27	88	9.5	21	70A
6657011197-102	Pro-Series 1000 G 12V 7mm Kit*	503	12 V	700 W	454	1000	32	105	113	250	50A	27	88	9.5	21	70A
6657011198-102	Pro-Series 1000 G 12V 8mm Kit*	504	12 V	700 W	454	1000	32	105	113	250	50A	27	88	9.5	21	70A

Part numbers above are not available in the USA.

* Kits include: windlass, base gasket seal, fast mounting studs, installation wrench, toggle switch and circuit breaker.

Pro-Series 1000 is supplied with dual-direction solenoid and also has rocker switch instead of toggle.

USA Version Kit* Numbers

6656011107-301	Pro-Series 700 Kit*	503	12 V	500 W	320	700	32	105	79	175	35A	27	88	8.5	19	50A
6657011108-102	Pro-Series 1000 Kit*	516	12 V	700 W	454	1000	32	105	113	250	50A	27	88	9.5	21	70A

* Kits include: windlass, base gasket seal, fast mounting studs, installation wrench, toggle switch and circuit breaker.

Pro-Series 1000 is supplied with dual-direction solenoid and also has rocker switch instead of toggle.

Pro-Series Gypsy Specifications

Gypsy Number	Chain Description	Rope Description		
		mm	in	
502*	6mm DIN766	12mm	1/2	3-strand and 8-plait
503	1/4" G4, 1/4" BBB, 7mm DIN 766	12mm	1/2	3-strand and 8-plait
516	5/16" G4	14-16mm	9/16-5/8	3-strand and 8-plait (5/8 only)
504*	8mm DIN 766, 5/16" BBB	14-16mm	9/16-5/8	3-strand and 8-plait (5/8 only)

* Not available in the USA.

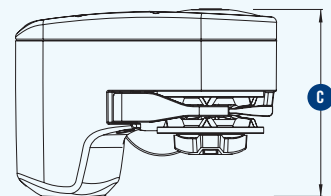
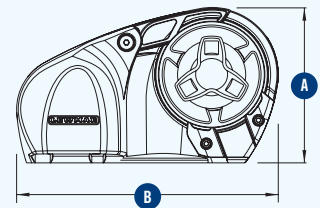

Pro-Series Dimensions

Model	A		B		C	
	mm	in	mm	in	mm	in
700	146	5 3/4	245	9 5/8	178	7
1000	146	5 3/4	245	9 5/8	178	7

* If fitting under deck, please allow for at least 20mm / 3/4" control arm travel when unit is running.

Cable Selection

Product	Voltage	Length of Cable Run		Switch Wiring	Current rating for switch wire
		0-7m / 0'- 23'	7-15m / 23'- 50'		
Pro-series 700	12V	10mm ² / 10 AWG	16mm ² / 6 AWG	1.5mm ² / 16 AWG	5A
Pro-series 1000	12V	10mm ² / 8 AWG	16mm ² / 4 AWG	1.5mm ² / 16 AWG	5A

The above cable sizes are recommendations only.

Pro-Fish

The ultimate windlass for fishermen, the horizontal Pro-Fish has an automatic freefall that allows you to pull right up over a wreck or ledge, and drop anchor with speed and precision. No more running your motor or wasting fuel while you “hover fish.” And you can retrieve your anchor just as easily, with the push of a button. Plus, the Pro-Fish is DIY-ready and made of durable 100% 316 stainless steel.



Features

- Automatic freefall
- Powerful motor providing fast line retrieval speed
- Manual emergency recovery equipped – all you need is a common 1/2” socket wrench
- Strong 100% 316 stainless steel, including control arm and stripper
- Maximum pulling power: 320kg (700 lbs) for the 700 and 454kg (1,000 lbs) for the 1000
- Convenient above-deck installation
- 5-year warranty





Pro-Fish Windlass Specifications

Part Number	Description	Gypsy No.	Motor Power Option	Typical Power Watts	Typical Max Pull		Maximum Line Speed		Working Load		Normal Current Draw	Typical Line Speed/min		Weight		Circuit Breaker
					kg	lb	m	ft	kg	lb		m	ft	kg	lb	
6656211196-301	Pro-Fish 700 G 12V 6mm Kit*	502	12 V	500 W	320	700	32	105	79	175	35A	27	88	8.5	19	50A
6656211197-301	Pro-Fish 700 G 12V 7mm Kit*	503	12 V	500 W	320	700	32	105	79	175	35A	27	88	8.5	19	50A
6656411197-102	Pro-Fish 1000 G 12V 7mm Kit**	503	12 V	700 W	454	1000	32	105	113	250	50A	27	88	9.5	21	70A
6656411198-102	Pro-Fish 1000 G 12V 8mm Kit**	504	12 V	700 W	454	1000	32	105	113	250	50A	27	88	9.5	21	70A

Part numbers above are not available in the USA.

* Kits include: windlass, base gasket seal, fast mounting studs, installation wrench, toggle switch and circuit breaker.

** Pro-Fish 1000 is supplied with dual-direction contactor, and also has rocker switch instead of toggle.

USA Version Kit* Numbers

6656211107-301	Pro-Fish 700 Kit	503	12 V	500 W	320	700	32	105	79	175	35A	27	88	8.5	19	50A
6656411108-102	Pro-Fish 1000 Kit**	516	12 V	700 W	454	1000	32	105	113	250	50A	27	88	9.5	21	70A

* Kits include: windlass, base gasket seal, fast mounting studs, installation wrench, toggle switch and circuit breaker.

** Pro-Fish 1000 is supplied with dual-direction contactor, and also has rocker switch instead of toggle.

Pro-Fish Gypsy Specifications

Gypsy Number	Chain Description	Rope Description		
		mm	in	
502*	6mm DIN766	12	1/2	3-strand and 8-plait
503	1/4" G4, 1/4" BBB, 7mm DIN 766	12	1/2	3-strand and 8-plait
516	5/16" G4	14-16	9/16-5/8	3-strand and 8-plait (5/8 only)
504*	8mm DIN 766, 5/16" BBB	14-16	9/16-5/8	3-strand and 8-plait (5/8 only)

* Not available in the USA.

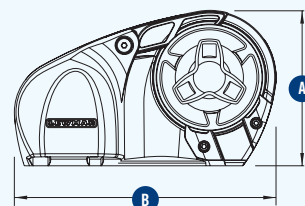

Pro-Fish Dimensions

Model	A		B		C	
	mm	in	mm	in	mm	in
700	146	5 3/4	245	9 5/8	178	7
1000	146	5 3/4	245	9 5/8	178	7

* If fitting under deck, please allow for at least 20mm / 3/4" control arm travel when unit is running.

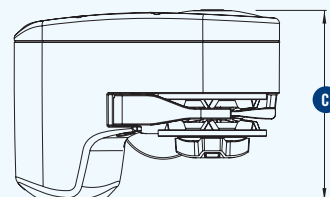

Cable Selection

Product	Voltage	Length of Cable Run		Switch Wiring	Current rating for switch wire
		0-7m / 0' - 23'	7-15m / 23' - 50'		
Pro-fish 700	12V	10mm ² / 10 AWG	16mm ² / 6 AWG	1.5mm ² / 16 AWG	5A
Pro-fish 1000	12V	10mm ² / 8 AWG	16mm ² / 4 AWG	1.5mm ² / 16 AWG	5A

The above cable sizes are recommendations only.



H-Series

The stylish, horizontal H-Series Windlasses use the same reliable worm gearbox technology that Lewmar developed for the V-Series Windlass range. The integral contactor simplifies wiring and is protected by a durable maincase. The unit's waterproof seal requires minimum maintenance, and since you can install it in one piece, getting started is quick and easy.

Features

- Quick, easy, one-piece installation
- Robust horizontal worm motor-gearbox for reliable performance
- Integral contactor protected by maincase
- Sealed waterproof unit requires minimum maintenance
- Aluminum and composite maincase for reduced weight
- Stainless steel warping drum with unique “Wear and Abrasion Reduction Pattern” finish
- H2/3's now come with reed switch and magnet fitted as standard for chain counter applications



H2 & H3 Complete Unit Specifications

Part Number <i>(Gypsy only)</i>	Part Number <i>(Gypsy/Drum)</i>	Motor Power		Rope Size		Chain Size		Gypsy No.	Motor Watts	Typical Max Pull		Max Line Speed/min		Working Load		Normal Current Draw	Normal Line Speed/min		Weight Gypsy Only		Weight Gypsy Drum		Circuit Breaker <i>(Slow Blow)</i>
		Model	Option	mm	in	mm	in			kg	lb	m	ft	kg	lb		m	ft	kg	lb	kg	lb	
69600533	69600537	H2	12V	14-16	9/16-5/8	8	5/16	505	700W	650	1433	21	69	163	358	80A	17	56	21.5	47	23.5	52	90A
69600534	69600538	H2	12V	14-16	9/16-5/8	10	3/8	506	700W	650	1433	21	69	163	358	80A	17	56	21.5	47	23.5	52	90A
69600535	69600539	H2	24V	14-16	9/16-5/8	8	5/16	505	900W	760	1675	24	79	190	419	45A	19	62	21.5	47	23.5	52	50A
69600536	69600540	H2	24V	14-16	9/16-5/8	10	3/8	506	900W	760	1675	24	79	190	419	45A	19	62	21.5	47	23.5	52	50A
69600541	69600545	H3	12V	14-16	9/16-5/8	8	5/16	505	1000W	860	1962	28	92	215	475	85A	18	59	23.5	52	25.5	56	110A
69600542	69600546	H3	12V	14-16	9/16-5/8	10	3/8	506	1000W	860	1962	28	92	215	475	85A	18	59	23.5	52	25.5	56	110A
69600543	69600547	H3	24V	14-16	9/16-5/8	8	5/16	505	1000W	1020	2248	30	98	243	535	60A	20	66	23.5	52	25.5	56	90A
69600544	69600548	H3	24V	14-16	9/16-5/8	10	3/8	506	1000W	1020	2248	30	98	243	535	60A	20	66	23.5	52	25.5	56	90A

• Kits include: Built-in dual-direction contactor, breaker and rocker switch.

For cable specifications refer to p. 24



H2 & H3 Gypsy Specifications

Gypsy Number	Size	Chain Description	mm	in	Rope Description
505	8mm	5/16" BBB, 5/16" US G4 ISO, 8mm DIN 766	14-16	9/16-5/8	3-strand and 8-plait (5/8 only)
506	10mm	3/8" BBB, 10mm DIN 766	14-16	9/16-5/8	3-strand and 8-plait (5/8 only)

• 3/8 G4 HT Chain will not fit in the 506 gypsy.

H2 & H3 Dimensions

Model	A		B		C		D	
	mm	in	mm	in	mm	in	mm	in
H2 & H3	212	8 5/16	365	14 3/8	273	10 3/4	361	14 1/4

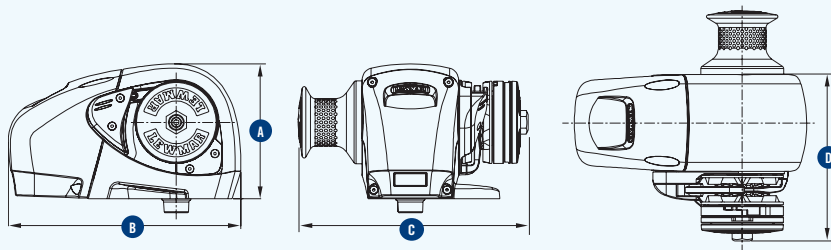

Manual Recovery Kit

Available on the H2/H3 as an optional extra, it remains fitted to the unit for user convenience.

Part No.	Description
66840045	M/R Kit H2/H3

V700 Vertical Windlass



With 100% 316 stainless steel housing and a sleek flush-mount design that hides the motor down below, the V700 is one of the most attractive and durable windlasses on the market. It works at the push of a button and has two built-in features that make it unique – motor protection and anchor lock. Plus it's affordable.

Features

- 100% 316 stainless steel deck unit
- IP677 Rated (Waterproof to 1 meter)
- Fall Safe anchor lock
- Built-in anchor lock for positive gypsy lock to base plate
- Fast line speed, manual recovery option
- Impact-resistant motor cover
- 5-year warranty
- For boats 6m-10m (20-32 ft)
- With reed switch and magnet fitted as standard for chain counter applications

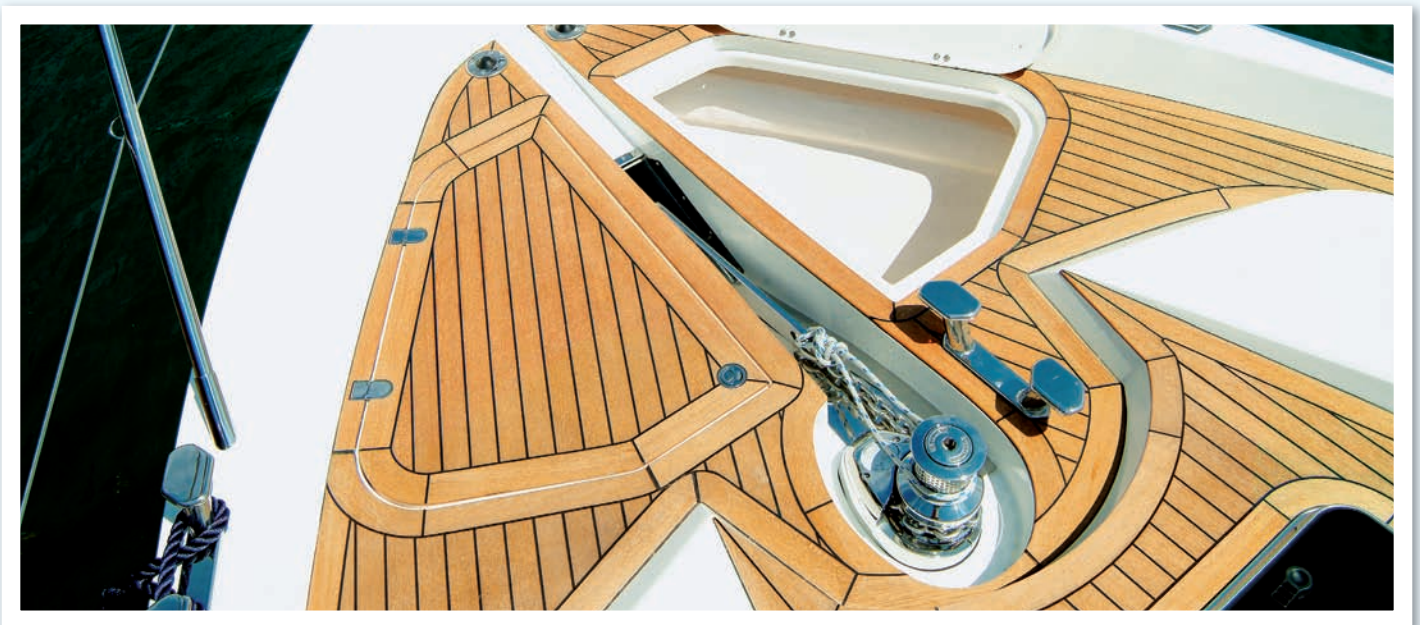



V700 Specifications

Part Number	Description	Model	Gypsy No.	Motor Power Option	Typical Power Watts	Typical Max Pull		Maximum Line Speed		Working Load		Normal Current Draw	Typical Line Speed/min		Weight Gypsy Only		Circuit Breaker
						kg	lb	m	ft	kg	lb		m	ft	kg	lb	
6670011196-302	V700 12V 6mm kit* V700	602	12V	320W	320	700	25	82	79	175	45A	15	50	6.5	14	35A	
6670011197-302	V700 12V 7mm kit* V700	603	12V	320W	320	700	25	82	79	175	45A	15	50	6.5	14	35A	

Part numbers above are not available in the USA.

* Kit includes: Breaker and toggle switch.

V700's come with read switch and magnet fitted as standard for chain counter applications.

USA Version Kit

6670011107-302	V700 Kit*	V700	603	12V	320W	320	700	25	82	79	175	45A	15	50	6.5	14	35A
----------------	-----------	------	-----	-----	------	-----	-----	----	----	----	-----	-----	----	----	-----	----	-----

* Kit includes: Breaker and toggle switch.

V700's come with read switch and magnet fitted as standard for chain counter applications.

V700 Gypsy Specifications

Gypsy Number	Size	Chain Description	Rope Description		
			mm	in	
602	6mm	6mm DIN 766	12	1/2	3-strand and 8-plait
603	7mm	1/4" G4 or BBB, 7mm DIN 766	12	1/2	3-strand and 8-plait

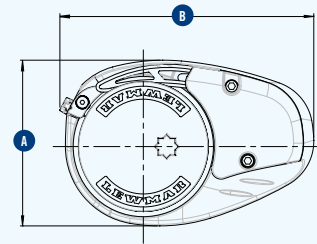

V700 Dimensions

Model	A		B		C		D	
	mm	in	mm	in	mm	in	mm	in
V700	128	5	196	7	69	3	202	8

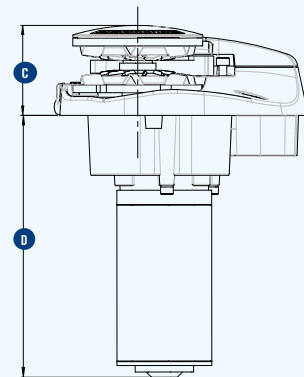

Cable Sizes

Product	Voltage	Length of Cable Run		Switch Wiring	Current rating for switch wire
		0-7m / 0'- 23'	7-15m / 23'- 50'		
V700	12V	10mm ² / 8 AWG	10mm ² / 8 AWG	1.5mm ² / 16 AWG	5A

The above cable sizes are recommendations only.

V-Series Vertical Windlass



The world's first compact vertical stainless steel windlass for both power and sailboats, this beautifully styled deck unit conceals a robust, reliable, worm gearbox and offers maximum strength and control. Plus, you can employ rope-chain or all-chain anchor rodes with the touch of a button. And the V1, V2 and V3 are all FastFit™ equipped, which means you can install them quickly and easily and ensure proper drive shaft alignment.

Fast Fit

FastFit™ ensures fast, hassle-free installation and proper drive shaft alignment. V1, V2 and V3 windlasses are available with FastFit™



(Model shown has manual override)

Features

- Rope-chain gypsy
- Manual override and chain release (optional)
- Cone clutch for smooth, easy control
- Robust and reliable drive train
- FastFit™ for quicker installation and less hassle
- V1/V2/V3's now come with reed switch and magnet fitted as standard for chain counter applications

FastFit™ Assembly





V1, V2 & V3 Specifications

Model	Power Option	Motor Watts	Typical Max Pull		Typical Max Line Speed/min		Working Load		Normal Current Draw	Line Speed/min		Weight Gypsy Only		Weight Gypsy/Drum		Circuit Breaker (Slow Blow)
			kg	lb	m	ft	kg	lb		m	ft	kg	lb	kg	lb	
V1	12V	700W	454	1000	19	65	113	250	80A	13	43	16.5	36	-	-	90A
V1 MO	12V	700W	454	1000	19	65	113	250	80A	13	43	16.5	36	-	-	90A
V2	12V	700W	650	1433	21	69	163	358	80A	14	46	16.5	36	19.5	43	90A
V2	24V	900W	760	1675	24	79	180	396	45A	16	53	9.5	21	19.5	43	50A
V3	12V	1000W	890	1962	28	92	215	473	85A	18	59	18.5	40	21.5	47	110A
V3	24V	1000W	1020	2248	30	98	243	535	60A	20	66	11.5	25	21.5	47	90A

V1/V2/V3 Kit Numbers*

Part Number		Model	Gypsy No.	Voltage
Gypsy Only	Gypsy Drum			
6671011107-138 (USA Only)	-	V1	000	12V
6671011108-138 (USA Only)	-	V1	002	12V
6671011196-138	-	V1	006	12V
6671011197-138	-	V1	000	12V
6671011198-138	-	V1	001	12V
6671011696-138	-	V1 MO	006	12V
6671011697-138	-	V1 MO	000	12V
6671011698-138	-	V1 MO	001	12V
6672011196-138	6672021196-138	V2	006	12V
6672011197-138	6672021197-138	V2	000	12V
6672011198-138	6672021198-138	V2	001	12V
6672011108-138	6672021108-138	V2	002	12V
6672011110-138	6672021110-138	V2	003	12V
6672012196-140	6672022196-140	V2	006	24V
6672012197-140	6672022197-140	V2	000	24V
6672012198-140	6672022198-140	V2	001	24V
6672012108-140	6672022108-140	V2	002	24V
6672012110-140	6672022110-140	V2	003	24V
6672211196-139	6672221196-139	V3	006	12V
6672211197-139	6672221197-139	V3	000	12V
6672211198-139	6672221198-139	V3	001	12V
6672211108-139	6672221108-139	V3	002	12V
6672211110-139	6672221110-139	V3	003	12V
6672212196-142	6672222196-142	V3	006	24V
6672212197-142	6672222197-142	V3	000	24V
6672212198-142	6672222198-142	V3	001	24V
6672212108-142	6672222108-142	V3	002	24V
6672212110-142	6672222110-142	V3	003	24V

Emergency Manual Recovery Kits

66840054		V1	-
66840054	66840056	V2/V3	-

*Kit includes windlass, rocker switch, circuit breaker, contactor and winch handle.

V1/V2/V3 Dimensions

Model	Above Deck				Below Deck																							
	D	H1	H2	L	A	B	C	E	F	G	J	K	M	N														
	mm	in	mm	in	mm	in	mm	in	mm	in	mm	in	mm	in	mm	in												
V1	-	-	92	3 3/8	-	-	42	1 13/16	62.5	2 3/8	70	2 3/4	310	12 3/16	173	6 13/16	161	6 3/16	157	6 3/16	70	2.76	161	6 3/16	237	9 1/8	114	4 1/4
V2	75	3	92	3 3/16	168	6 5/8	42	1 9/16	62.5	2 3/8	70	2 3/4	310	12 3/16	173	6 13/16	161	6 3/16	157	6 3/16	70	2.76	161	6 3/16	237	9 1/8	114	4 1/4
V3	75	3	92	3 3/16	168	6 5/8	42	1 9/16	62.5	2 3/8	70	2 3/4	315	12 3/8	173	6 13/16	161	6 3/16	157	6 3/16	70	2.76	161	6 3/16	237	9 1/8	114	4 1/4

• Maximum Deck Thickness for V1/V2/V3 is 60mm / 2 1/4". Longer shaft versions available on request.

V1/V2/V3 Gypsy Specifications

Part Number	Gypsy No	Chain Description	Rope Description		3-strand and 8-plait
			mm	in	
68000840	006	6mm ISO, 1/4" Acco G40, 1/4" BBB	12-14	1/2	3-strand and 8-plait
68000360	000	7mm ISO, 1/4" Acco G40, 1/4" BBB	12-14	1/2	3-strand and 8-plait
68000361	001	8mm DIN 766, 8mm ISO	12-16	1/2-5/8	3-strand and 8-plait (5/8 only)
68000362	002	10mm DIN 766, 5/16" G40, 9.5mm ISO Campbell 3/8" S4	12-16	1/2-5/8	3-strand and 8-plait (5/8 only)
68000363	003	10mm ISO, Campbell 3/8" S3, 3/8" G80, 3/8" G40 ISO	16	5/8	3-strand and 8-plait

For cable specifications refer to p. 24

ABOVE DECK DIMENSIONS

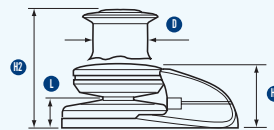

V1/V2/V3

BELOW DECK DIMENSIONS

Side Elevation

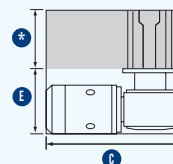

V1/V2/V3

Plan Elevation

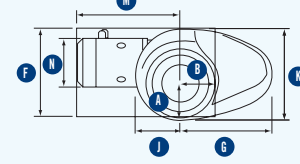

V1/V2/V3

V4/V5 Vertical Windlass



Features

- Rope-chain gypsy
- Manual override and chain release (optional)
- Cone clutch for smooth, easy control
- Robust and reliable drive train
- Now come with read switch and magnet fitted as standard for chain counter applications



V4 & V5 Specifications

Part Number	Model	Description	Power Option	Motor Watts	Max Pull		Max Line Speed/min		Typical Working Load		Normal Current Draw	Normal Line Speed/min		Weight		Circuit Breaker (Slow Blow)
					kg	lb	m	ft	kg	lb		m	ft	kg	lb	
66810024	V4/V5	Deck Unit Gypsy Only												13.0	29	
66810025	V4/V5	Deck Unit Gypsy/Drum												15.5	34	
68000534	V4	12V Mtr/Gearbox	12V	1600W	1360	2998	25	82	136	300	125A	15	49	13.5	30	150A
68000535	V4	24V Mtr/Gearbox	24V	2000W	1600	3528	27	90	136	300	70A	16	53	13.5	30	110A
66810011	V5	12V Mtr/Gearbox	12V	2000W	1860	4100	27	90	136	300	120A	17	56	15.5	34	150A
66810012	V5	24V Mtr/Gearbox	24V	2000W	2000	4410	29	97	136	300	60A	18	59	15.5	34	110A

V4/V5's now come with read switch and magnet fitted as standard for chain counter applications.

V4/V5 Gypsy Specifications

Part Number	Gypsy No	Chain description	Rope Description	
			mm	in
68000356	201	8mm DIN 766, 8mm ISO, 5/16" G40, 5/16" Campbell S4	12-14	1/2
68000357	202	9.5mm ISO, 10mm DIN 766, 5/16" Campbell S3, 3/8" Campbell S4	16	5/8
68000358	203	10mm ISO, 3/8" G40 ISO, 3/8" Acco G80, 3/8" Campbell S3	16	5/8
68000359	204	12mm ISO, 13mm DIN 766, 7/16" G40	18-20	3/4

V4/V5 Hydraulic Motor/Gearbox

Part Number	Model	Normal Pressure	Flow Rate	Typical Max Pull		Max Line Speed	
				kg	lb	m	ft
68000294	V4/V5	175 bar	10-40 l/min	1100 at	2400 at	21 at	69 at
		2537 psi (cont)	2.6-10.6 US gal/min	14 bar	203 psi	40 l/min	10.6 US gal/min

Hydraulic motor/gearboxes are suitable for use with both V4/V5 and C4/C5.

V4/V5 Kit Numbers*

Part Number	Item Description
66910078-143	12V 201 KIT
66910079-143	12V 202 KIT
66910080-143	12V 203 KIT
66910081-143	12V 204 KIT
66910082-144	24V 201 KIT
66910083-144	24V 202 KIT
66910084-144	24V 203 KIT
66910085-144	24V 204 KIT
66910098-146	24V 201 KIT
66910099-146	24V 202 KIT
66910100-146	24V 203 KIT
66910101-146	24V 204 KIT
66840003	Gypsy only Emergency manual override KIT
66840005	Gypsy drum Emergency manual override KIT

* Kit includes: rocker switch, circuit breaker, contactor and handle.



ARM Kit

Part Number	Description
66810031	V4/V5 Arm Kit

For circuit breaker, contactor, switch and accessories refer to p. 25

For cable specifications refer to p. 24

ABOVE DECK DIMENSIONS

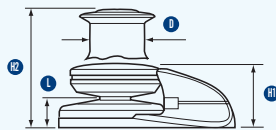

V4/V5

BELOW DECK DIMENSIONS

Side Elevation

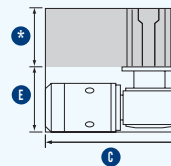

V4/V5

Plan Elevation

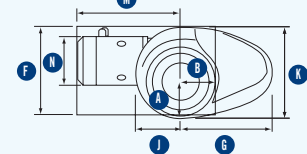

V4/V5

maximum deck thickness

V Series Dimensions

	D		H1		H2		L		A		B		C		E		F		G		J		K		M		N		*	
Model	mm	in	mm	in	mm	in	mm	in	mm	in	mm	in	mm	in	mm	in	mm	in	mm	in	mm	in	mm	in	mm	in	mm	in	mm	in
V4	91	2 7/16	107	4 1/4	215	8 7/16	51	2	74	2 7/8	89	3 1/2	366	14 1/16	186	7 5/16	215	8 7/16	185	7 1/4	93	3 11/16	188	7 7/16	277	10 7/8	112	4 7/16	125	4 15/16
V5	91	2 7/16	107	4 1/4	215	8 7/16	51	2	74	2 7/8	89	3 1/2	378	14 7/8	174	6 7/8	222	8 3/4	185	7 1/4	93	3 11/16	188	7 7/16	289	11 3/8	125	4 15/16	125	4 15/16

Pacific V4000 & V6000

The Pacific V4000 is designed to fit any boat up to 25m (82 ft) and the Pacific V6000 up to 36m (120 ft). Fitted with an epicyclic gearbox, the V4000 and V6000 transmit motor power to pulling power with maximum mechanical efficiency. The one-piece motor and gearbox configuration facilitates easy installation and will accommodate any deck thickness. Pacific V4000 & V6000 have a chain-only gypsy with an independent drum to assist warping when required. Emergency manual recovery is provided as standard should battery power be lost.

Power options available include 12V and 24V.

Please contact your nearest Lewmar office for more information.



Pacific V4000
Gypsy/Drum
Not available in the USA.

Pacific V4000 & V6000 Specifications

Complete Unit*	Switch Kit**	Model	Gypsy No.	Power Options	Motor Watts	Typical Max Pull		Max Line Speed		Typical Working Load		Normal Current Draw	Normal Line Speed/min		Weight		Circuit Breaker (Slow Blow)
						kg	lb	m/min	ft/min	kg	lb		m	ft	kg	lb	
0034021210	104	V4000	310	12V	1200W	1630	3590	14	46	363	800	100A	10	33	52	114	110A
0034021212	104	V4000	311	12V	1200W	1630	3590	14	46	363	800	100A	10	33	52	114	110A
0034021214	104	V4000	312	12V	1200W	1630	3590	14	46	363	800	100A	10	33	52	114	110A
0034022210	206	V4000	310	24V	1200W	1750	3850	14	46	363	800	55A	11	36	52	114	70A
0034022212	206	V4000	311	24V	1200W	1750	3850	14	46	363	800	55A	11	36	52	114	70A
0034022214	206	V4000	312	24V	1200W	1750	3850	14	46	363	800	55A	11	36	52	114	70A
0036022212	207	V6000	313	24V	1500W	2730	6000	12	40	544	1200	80A	9	30	88	193	110A
0036022214	207	V6000	314	24V	1500W	2730	6000	12	40	544	1200	80A	9	30	88	193	110A
0036022216	207	V6000	315	24V	1500W	2730	6000	12	40	544	1200	80A	9	30	88	193	110A

*Complete units include deck unit, gypsy and motor/gearbox.

**Switch Kits include a contactor, circuit breaker and guarded rocker switch.

Pacific V4000 & V6000 Dimensions

Model	Above Deck				Below Deck					
	mm	in	mm	in	mm	in	mm	in		
V4000	236	9 $\frac{1}{4}$	286	11 $\frac{3}{4}$	370	14 $\frac{5}{8}$	350	13 $\frac{3}{4}$	180	7
V6000	295	11 $\frac{1}{2}$	356	14	450	17 $\frac{3}{4}$	383	15	240	9 $\frac{1}{2}$

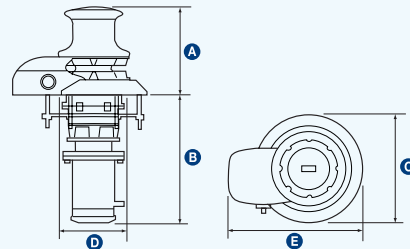

Gypsy Specifications

Gypsy Number	Chain Description
310	3/8" US ACCO BBB, 3/8" US G4 ISO, 10mm DIN 766
311	7/16" US G4 ISO, 1/2" US G3 ISO, 13mm DIN 766
312	1/2" US G4 ISO
313	1/2" US G7 ISO, 13mm DIN 766
314	5/8" US G4 ISO, 16mm DIN 766
315	16mm ISO 4565, 16mm DIN 766

For cable specifications refer to p. 24

Lewmar 3000 Windlass

The rugged and durable 3000 series windlass is suitable for boats 18m (60 ft) to 24m (80 ft).

Features

- Strip-from-the-top easy servicing
- Independent drum operation
- Polished bronze finish available
- Manual chain release and brake
- Manufactured from all marine grade materials
- Fast and powerful anchor recovery
- CE approved
- Splined stainless steel shaft for maximum strength
- Duplex nickel chrome plate or polished bronze finish for durability and long-lasting stylish looks
- Powerful hydraulic and electric motor/gearboxes
- Large diameter warping drum and cleat
- Needle peened capstan for extra grip
- Powered or manual chain release
- Full-power backwind
- Independent capstan operation
- Compact design and simple to install
- Gypsy-only and capstan-only versions are available
- Chain pipe required



3000 Gypsy Drum

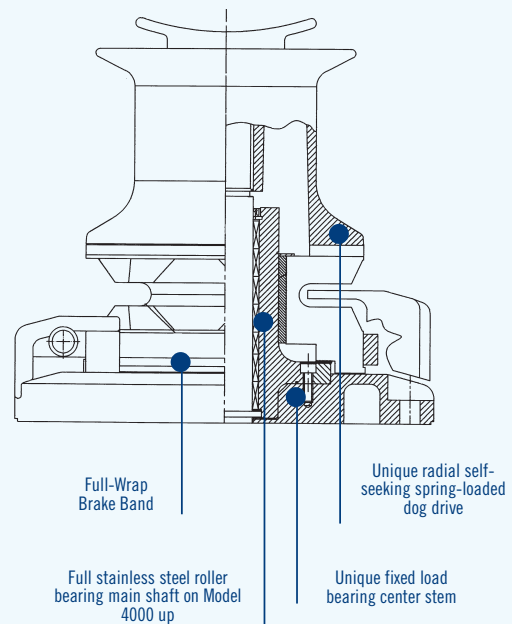

Stand Off from Base

68000024

Universal 8–13mm
5/16"–1/2" Chain Pipe



Close Coupled to the Base

68000023

LH-Stb Hand Bow Roller Windlass
10–13mm 3/8"–1/2" Chain Pipe



3000 Gypsy/Drum



3000 Gypsy



3000 Capstan

3000 - Gypsy and Gypsy/Drum Specifications

Part Number	Description	Power Options	Motor Watts	Max Pressure bar	psi (Intl)	Flow Rate (US) l/min gal/min	Typical Max Pull kg	lb	Max Line Speed/m ft	Typical Working load		Normal Line Speed/min		Weight	
										kg	lb	m	ft	kg	lb
Deck Units (Gypsy not included)															
68000015	Gypsy Drum													19	41.8
68000016	Gypsy Only													13	28.6
68000049	Capstan													13	28.6
Gypsy Units															
68000570	Gypsy Unit 301														
68000571	Gypsy Unit 302														
68000572	Gypsy Unit 303														
68000573	Gypsy Unit 304														
Motor / Gearbox Units															
68000518	12V Mtr/Gearbox	12V	3000W				1400	3087	16	52	213	469	140A	9	30
68000489	24V Mtr/Gearbox	24V	1500W				1800	3960	16	52	213	469	60A	13	43
68000017	Hyd Mtr/Gearbox	Hyd		175	2538	10-60	2.6-15.8	1645*	3620*	40	131**	213	469	15	50***

* @ 175bar (2538psi) ** 60l (15.8 US gal) min. *** 20l (5.2 US gal) min. Motor gearbox and circuit breaker options apply to capstan.

3000 Series Dimensions

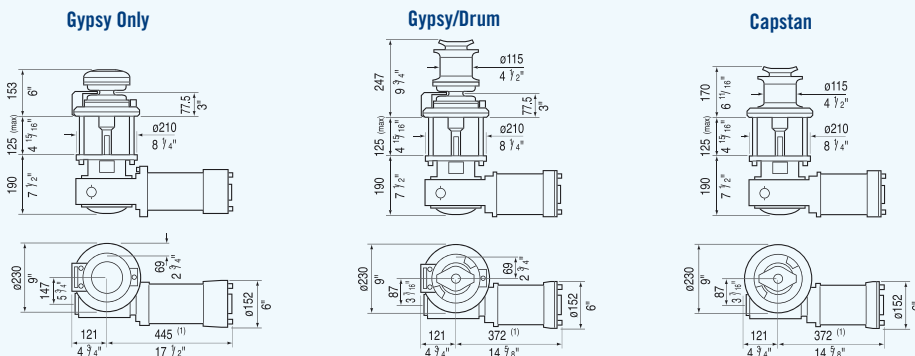

Hydraulic dimensions: (1) 293mm (12¹¹/₁₆"), (2) 70mm (2³/₄")

Gypsy Kit

3000 Chain Gypsies

Part Number	Gypsy No.	Description
68000570	301M	10mm ISO, 3/8" G40, 3/8" BBB 3/8" Campbell S3/S4, 10mm DIN 766 Lewmar B2504 G30 10mm Lewmar B2510 G40 10mm
68000571	302M	12mm ISO, 13mm DIN 766 7/16" G40
68000572	303M	1/2" G40, 1/2" Campbell S3/S4 Lewmar 2503 G30 12mm Lewmar 2505 G40 12mm
68000573	304M	14mm ISO, 9/16" BBB Lewmar 2516 G30 14mm Lewmar 2515 G40 14mm

For circuit breaker, contactor, switch and accessories refer to p. 25

For cable specifications refer to p. 24

Lewmar 3500-8000 Series

The Lewmar custom series of mega and super yacht windlasses offers superb quality, performance and strength. For boats 21.3m (70 ft) to 30.5m (100 ft).

Features

- Duplex nickel chrome plate or polished bronze finish for durability and long-lasting stylish looks
- Powerful hydraulic and electric motor/gearboxes
- Large diameter warping drum and cleat
- Needle peened drum for extra grip
- Powered or manual chain release
- Full-power backwind
- Independent drum operation
- Compact design and simple to install
- Capstans provide controlled and secure mooring and docking
- Gypsy-Only and Capstan-Only versions are available
- Unique load-bearing center stem



3500
Vertical Gypsy/Drum



4000
Vertical Gypsy/Drum

Lewmar 3500-4000 Series

Part Number	Description	Chain Size	Power Options	Motor Watts	Max Pressure		Min/Max Flow Rate (US)		Typical Max Pull		Min/Max Line Speed		Typical Working Load		Normal Line Speed/min	Weight	
					bar	psi (Int'l)	l/min	gal/min	kg	lb	kg	lb	kg	lb			
3500 Series																	
68000027	L/H G/D Deck Unit															25	55
68000043	R/H G/D Deck Unit															25	55
60000219	VH Gypsy Deck Unit		Hyd														
68000574	Gypsy Kit 351	10mm/3/8"															
68000575	Gypsy Kit 352	12mm/7/16"															
68000576	Gypsy Kit 353	1/2"															
68000577	Gypsy Kit 354	14mm															
68000489	24V Mtrr/Gearbox		24V	1.5kW Nominal					1600	3520		4-16m	213	469	14m (46ft)/min (13-52ft)/min	31	68
68000017	Hyd Mtrr/Gearbox		Hyd		140 cont 175	2035 cont 2538	10-40	2.6-10.6	1300 1600	2860 3520		8-29m (26-95ft)/min	213	469	Dependent on Power Pack	28	62
68000525	24V Control Box		24V														
4000 Series																	
60000304	L/H Gypsy/Drum		24V	3.75kW					1818	4000		9-15m (29-49ft)/min	363	800	14m (46ft)/min	130	286
60000305	R/H Gypsy/Drum		24V	3.75kW					1818	4000		9-15m (29-49ft)/min	363	800	14m (46ft)/min	130	286
68000114	L/H Gypsy/Drum		Hyd		120 cont 1740 cont		20-40	5.2-10.6	1850	4080		9-19m (29-63ft)/min	363	800	Power Pack	125	275
68000115	R/H Gypsy/Drum		Hyd		120 cont 1740 cont		20-40	5.2-10.6	1850	4080		9-19m (29-63ft)/min	363	800	Power Pack	125	275
60000127	VH Capstan		Hyd		120 cont 1740 cont		20-40	5.2-10.6	1850	4080		9-19m (29-63ft)/min	363	800	Power Pack	125	275
60000184	GYP RH Windlass		Hyd		120 cont 1740 cont		20-40	5.2-10.6	1850	4080		9-19m (29-63ft)/min	363	800	Power Pack	125	275
60000369	GYP LH Windlass		Hyd		120 cont 1740 cont		20-40	5.2-10.6	1850	4080		9-19m (29-63ft)/min	363	800	Power Pack	125	275
68000099	Gypsy Kit 401	12mm/7/16"															
68000173	Gypsy Kit 402	14mm/1/2"															
68000174	Gypsy Kit 403	5/8"															
68000463	Gypsy Kit 404	16mm															
18000254	24V Control Box		24V														

Extended versions available on request.





5000 Vertical Gypsy/Drum



6000 Vertical Gypsy/Drum



8000 Vertical Gypsy/Drum



Hand Wheels
Customized hand wheels are available for all installations.

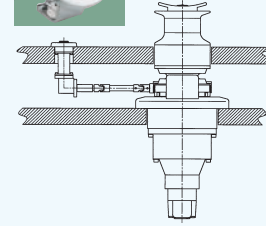

Lewmar 5000–8000 Series

Part Number	Description	Chain Size	Power Options	Max Pressure		Min/Max Flow Rate (US)		Typical Max Pull		Min/Max Line Speed		Typical Working Load		Weight	
				bar	psi (Int'l)	l/min	gal/min	kg	lb	kg	lb	kg	lb		
5000 Series															
68000112	L/H Gypsy/Drum		Hyd	140 cont 150	2030 cont 2175	20-40	5.2-10.6	2167 2275	4777 5015	9-19m (31-62ft)/min	454	1000	125	275	
68000113	R/H Gypsy/Drum		Hyd	140 cont 150	2030 cont 2175	20-40	5.2-10.6	2167 2275	4777 5015	9-19m (31-62ft)/min	454	1000	125	275	
68000116	L/H Gypsy/Drum		24V												
68000117	R/H Gypsy/Drum		24V												
68000217	Capstan		Hyd	140 cont	2030 cont	20-40	5.2-10.6	2167	4777	9-19m (31-62ft)/min	454	1000	125	75	
68000164	L/H Gypsy		Hyd	140 cont	2030 cont	20-40	5.2-10.6	2167	4777	9-19m (31-62ft)/min	454	1000	125	75	
68000211	R/H Gypsy		Hyd	140 cont	2030 cont	20-40	5.2-10.6	2167	4777	9-19m (31-62ft)/min	454	1000	125	75	
68000099	Gypsy Kit 401	12mm/ 7/16"											10	22	
68000173	Gypsy Kit 402	14mm/ 1/2"											10	22	
68000174	Gypsy Kit 403	5/8"											10	22	
68000463	Gypsy Kit 405	16mm											10	22	
6000 Series															
68000325	L/H Gypsy/Drum		Hyd	110 cont	1595 cont	30-70	7.9-18.5	2730	6018	8-19m (26-62ft)/min	544	1200	250	551	
68000326	R/H Gypsy/Drum		Hyd	110 cont	1595 cont	30-70	7.9-18.5	2730	6018	8-19m (26-62ft)/min	544	1200	250	551	
68000123	Capstan		Hyd	110 cont	1595 cont	30-70	7.9-18.5	2730	6018	8-19m (26-62ft)/min	544	1200	250	551	
68000425	16mm/ 5/8" Shortlink Gypsy												35	77	
60000143	19mm/ 3/4" Shortlink Gypsy												35	77	
8000 Series															
68000295	L/H Gypsy/Drum		Hyd	115 cont	1667 cont	30-70	7.9-18.5	3750	8267	6-15m (20-49ft)/min	726	1600	260	572	
68000296	R/H Gypsy/Drum		Hyd	115 cont	1667 cont	30-70	7.9-18.5	3750	8267	8-19m (26-62ft)/min	544	1200	260	572	
68000278	L/H Gypsy		Hyd	115 cont	1667 cont	30-70	7.9-18.5	3750	8267	8-19m (26-62ft)/min	544	1200	260	572	
68000368	R/H Gypsy		Hyd	115 cont	1667 cont	30-70	7.9-18.5	3750	8267	8-19m (26-62ft)/min	544	1200	260	572	
68000094	16mm/ 5/8" Shortlink Gypsy												35	77	
60000143	19mm/ 3/4" Shortlink Gypsy												35	77	

5000 – 8000 Dimensions

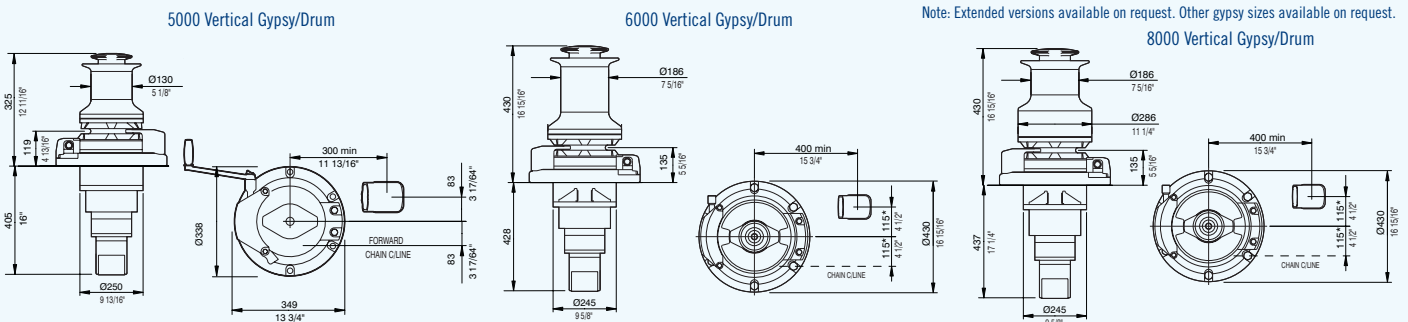

For 24V electric dimensions see 4000 windlasses.

Dimensions may vary depending on chain size.

Custom Model 10000 is based on the 8000 Series — Details on Application.
Note: Electric specifications dependent on motor.
Note: Extended versions available on request. Other gypsy sizes available on request.



C Series Capstans

Lewmar's C Series Capstans provide almost effortless rope control at the press of a footswitch. The WARP™ (Wear and Abrasion Resistant Pattern) finished drum optimizes performance and reduces rope wear by up to 30%. Stainless steel components combine strength, anti-corrosion and durability with a beautiful, polished finish. Installation of the C3 is quick and simple, as it is fastened entirely from above deck. This (patent pending) innovation cuts installation time by 35%.



C Series Capstan Specifications

Part Number	Model	Description	Power Option	Motor Watts	Typical Max Pull		Max Line Speed/min		Typical Working Load		Normal Current Draw	Normal Line Speed/min		Weight	
					kg	lb	m	ft	kg	lb		m	ft	kg	lb
6630331312	C3	12V Integrated Deck Unit & Motor Gearbox	12V	1000W	750	1850	12	39	45	100	65A	12	39	12.0	26
6630332312	C3	24V Integrated Deck Unit & Motor Gearbox	24V	1000W	850	2200	12	39	45	100	40A	12	39	11.5	25
66810032	C4/5	Deck Unit												11.5	25
68000534	C4	12V Motor Gearbox	12V	1600W	1360	2998	25	82	136	300	125A	15	49	13.5	30
68000535	C4	24V Motor Gearbox	24V	2000W	1600	3528	27	89	136	300	70A	16	53	13.5	30
66810011	C5	12V Motor Gearbox	12V	2000W	1860	4100	27	89	136	300	120A	17	56	15.5	34
66810012	C5	24V Motor Gearbox	24V	2000W	2000	4410	29	97	136	300	60A	18	59	15.5	34

Kit

Part Numbers

C Series Capstans

Part No.	Description
69600556	C-3 12V Capstan Kit*
69600557	C-3 24V Capstan Kit*
66910200	C-4 12V Capstan Kit**
66910201	C-4 24V Capstan Kit**
66910202	C-5 12V Capstan Kit**
66910203	C-5 24V Capstan Kit**

* Includes circuit breaker and footswitch.
 ** Includes contactor, circuit breaker and footswitch.

For cable specifications refer to p. 24



C4/C5 Hydraulic Motor Gearboxes

Part Number	Model	Normal Pressure	Flow Rate	Typical Max Pull		Max Line Speed	
				kg	lb	m	ft
68000294	C4/C5	175 bar	10-40 l/min	1100 at	2400 at	21 at	69 at
		2537 psi (cont)	2.6-10.6 US gal/min	14 bar	203 psi	40 l/min	10.6 US gal/min

Hydraulic motor/gearboxes are suitable for use with V4/V5 and C4/C5.

ABOVE-DECK DIMENSIONS

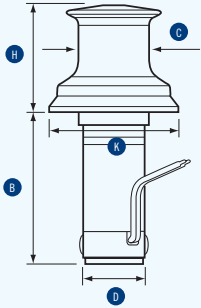

Side Elevation

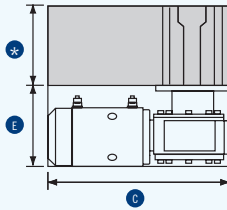

Plan Elevation

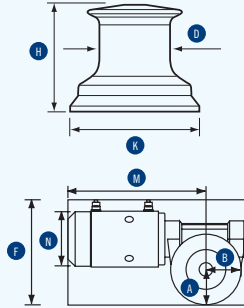

BELOW-DECK DIMENSIONS

C3 Dimensions

Model	Above Deck			Below Deck	
	C	H	K	B	D
C3	90 3 ³ / ₁₆	137 5 ³ / ₈	165 6 ¹ / ₂	194 7 ⁷ / ₈	80 3 ³ / ₈

C4/C5 Dimensions

Model	Above Deck						Below Deck				
	D	H	K	A	B	C	E	F	M	N	*
C4	108 4 ¹ / ₄	196 7 ³ / ₄	215 8 ¹ / ₂	74 2 ¹⁵ / ₁₆	89 3 ¹ / ₂	366 14 ⁷ / ₁₆	186 7 ⁷ / ₁₆	215 8 ¹ / ₂	277 10 ⁷ / ₈	112 4 ³ / ₈	125 4 ¹⁵ / ₁₆
C5	108 4 ¹ / ₄	196 7 ³ / ₄	215 8 ¹ / ₂	74 2 ¹⁵ / ₁₆	89 3 ¹ / ₂	378 14 ⁷ / ₈	172 6 ³ / ₄	222 8 ³ / ₄	289 11 ³ / ₈	125 4 ¹⁵ / ₁₆	125 4 ¹⁵ / ₁₆

Features

- Beautifully crafted stainless steel components give enduring strength and performance
- WARP™ finish drum - unique Wear and Abrasion Resistant Pattern reduces rope wear by 30%
- C3 offers quick, easy on-deck installation requiring only one person
- C4/C5's have worm gearbox-inherent anti-runback characteristics acting as a mechanical brake

Cable Specifications

Model	Voltage	Motor Power	Circuit Breaker	0-7m	0- 23'	7-15m	23- 50'	15-22m	50- 73'	Switch Wiring	Current rating for switch wire
C3	12V	1000W	70A	10mm ²	8 AWG	16mm ²	4 AWG			1.5mm ² 16 AWG	5A
C3	24V	1000W	50A	6mm ²	10 AWG	6mm ²	8 AWG			1.5mm ² 16 AWG	5A
C4	12V	1600W	150A	25mm ²	3 AWG	35mm ²	0 AWG	50mm ²	0 AWG	1.5mm ² 16 AWG	5A
C4	24V	2000W	110A	10mm ²	8 AWG	16mm ²	4 AWG	25mm ²	2AWG	1.5mm ² 16 AWG	5A
C5	12V	2000W	150A	25mm ²	3 AWG	35mm ²	0 AWG	50mm ²	0 AWG	1.5mm ² 16 AWG	5A
C5	24V	2000W	110A	10mm ²	8 AWG	16mm ²	4 AWG	25mm ²	2AWG	1.5mm ² 16 AWG	5A
V700	12V	250W	35A	10mm ²	8 AWG	10mm ²	8 AWG			1.5mm ² 16 AWG	5A
V1	12V	700W	90A	10mm ²	6 AWG	25mm ²	4 AWG			1.5mm ² 16 AWG	5A
V2	12V	700W	90A	10mm ²	6 AWG	25mm ²	4 AWG			1.5mm ² 16 AWG	5A
V2	24V	900W	50A	6mm ²	10 AWG	6mm ²	8 AWG			1.5mm ² 16 AWG	5A
V3	12V	1000W	110A	16mm ²	6 AWG	25mm ²	2 AWG			1.5mm ² 16 AWG	5A
V3	24V	1000W	90A	10mm ²	8 AWG	16mm ²	6 AWG			1.5mm ² 16 AWG	5A
V4	12V	1600W	150A	25mm ²	3 AWG	35mm ²	0 AWG	50mm ²	0 AWG	1.5mm ² 16 AWG	5A
V4	24V	2000W	110A	10mm ²	8 AWG	16mm ²	4 AWG	25mm ²	2AWG	1.5mm ² 16 AWG	5A
V5	12V	2000W	150A	25mm ²	3 AWG	35mm ²	0 AWG	50mm ²	0 AWG	1.5mm ² 16 AWG	5A
V5	24V	2000W	110A	10mm ²	8 AWG	16mm ²	4 AWG	25mm ²	2AWG	1.5mm ² 16 AWG	5A
Pacific V4000	12V	1200W	110A	16mm ²	6 AWG	25mm ²	2 AWG	35 mm ²	0 AWG	1.5mm ² 16 AWG	5A
Pacific V4000	24V	1200W	70A	6mm ²	10 AWG	10mm ²	8 AWG	16mm ²	6AWG	1.5mm ² 16 AWG	5A
Pacific V6000	24V	1500W	110A	10mm ²	8 AWG	16mm ²	4 AWG	25mm ²	2AWG	1.5mm ² 16 AWG	5A
3000	12V	3000W	225A	35mm ²	2 AWG	50mm ²	0 AWG	95mm ²	000 AWG	1.5mm ² 16 AWG	5A
3000	24V	1500W	160A	16mm ²	6 AWG	25mm ²	4 AWG	35 mm ²	0 AWG	1.5mm ² 16 AWG	5A
3500	24V	1500W	225A	16mm ²	6 AWG	25mm ²	2 AWG	50 mm ²	0 AWG	1.5mm ² 16 AWG	5A
4000/5000	24V	3750W	225A	16mm ²	6 AWG	25mm ²	2 AWG	50 mm ²	0 AWG	1.5mm ² 16 AWG	5A
PRO-SPORT	12V	150W	25A	6mm ²	10 AWG	6mm ²	8 AWG			1.5mm ² 16 AWG	5A
PRO-SERIES 700	12V	500W	50A	10mm ²	10 AWG	16mm ²	6 AWG			1.5mm ² 16 AWG	5A
PRO-SERIES 1000	12V	700W	70A	10mm ²	8 AWG	16mm ²	4 AWG			1.5mm ² 16 AWG	5A
PRO-FISH 700	12V	500W	50A	10mm ²	10 AWG	16mm ²	6 AWG			1.5mm ² 16 AWG	5A
PRO-FISH 1000	12V	700W	70A	10mm ²	8 AWG	16mm ²	4 AWG			1.5mm ² 16 AWG	5A
H2	12V	700W	90A	10mm ²	6 AWG	25mm ²	4 AWG			1.5mm ² 16 AWG	5A
H2	24V	900W	50A	6mm ²	10 AWG	6mm ²	8 AWG			1.5mm ² 16 AWG	5A
H3	12V	1000W	110A	16mm ²	6 AWG	25mm ²	2 AWG			1.5mm ² 16 AWG	5A
H3	24V	1000W	90A	10mm ²	8 AWG	16mm ²	6 AWG			1.5mm ² 16 AWG	5A

Circuit Breaker, Contactor, Switch and Accessories Guide:

After identifying your product, please follow three steps:

- ① Select Electrical Protection ② Select Operational Control ③ Choose Switch Type

Capstans

Horizontal Windlasses

Vertical Windlasses

Pro-Series/
Pro-Fish

Pro-Series/
Pro-Fish

Pacific Pacific

3500/
4000/
5000



①

Part #	Description	C3	C4/C5	Pro-Sport	700	1000	H2	H3	V700	V1	V2	V3	V4	V5	V4000	V6000	3000	5000
Circuit Breakers																		
68000603	Circuit Breaker (Slow Blow) 25A			12V														
68000604	Circuit Breaker (Slow Blow) 35A								12V									
68000348	Circuit Breaker (Slow Blow) 50A	24V			12V		24V			24V								
68000240	Circuit Breaker (Slow Blow) 70A	12V				12V									24V			
68000349	Circuit Breaker (Slow Blow) 90A						12V	24V		12V	12V	24V						
68000350	Circuit Breaker (Slow Blow) 110A		24V					12V				12V	24V	24V	12V	24V		
68000351	Circuit Breaker (Slow Blow) 150A		12V										12V	12V				
68000627	Circuit Breaker (Slow Blow) 160A															24V	24V	
68000628	Circuit Breaker (Slow Blow) 225A															12V	12V	24V

②

Single-Direction Contactors																		
0052505	Contactor 12V	•	•															
0052506	Contactor 24V	•	•															
Dual-Direction Contactors																		
68000318	Contactor 12V									•	•	•		•				
68000319	Contactor 24V									•	•	•		•				
68000320	Contactor 12V												•					
68000321	Contactor 24V												•					
0052531	Contactor (Dual) 12V PM			•	•	•			•									
Dual-Direction Control Boxes																		
68000129	Control Box (Dual) 12V									•	•	•		•				
68000130	Control Box (Dual) 24V									•	•	•		•				
18000200	Control Box (Dual) 12V												•					
18000237	Control Box (Dual) 24V												•					
68000519	Control Box (Dual) 12V																•	
68000490	Control Box (Dual) 24V																•	
0052509	Control Box (Dual) 12V PM			•	•	•			•									
0052529	Control Box (Dual) 12V SW															•		
0052530	Control Box (Dual) 24V SW															•		

③

Single-Direction Switch																		
69000346	Electric Deck Switch	•	•															
68000595	Heavy Duty Foot Switch (White)	•	•															
68000596	Heavy Duty Foot Switch (Black)	•	•															
48000170	Deck Switch Stainless Illuminated			•	•	•	•	•	•	•	•	•	•	•				
Dual-Direction Switch																		
0052519	Toggle Switch (Up/down)			•	•			•										
68000593	Guarded Rocker Switch (Up/Down)			•	•	•	•	•	•	•	•	•	•	•			•	•
68000524	Electric Remote Control (Up/Down)			•	•	•	•	•	•	•	•	•	•	•			•	•
68000597	Deck Foot Switch Set White (Up/Down)			•	•	•	•	•	•	•	•	•	•	•				
68000598	Deck Foot Switch Set Black (Up/Down)			•	•	•	•	•	•	•	•	•	•	•				
68000599	Hand-Held Control (Up/Down)			•	•	•	•	•	•	•	•	•	•	•			•	•
66830008	Chain Counter AA560R/C							•	•	•	•	•	•		•	•	•	•
Chain Counters																		
66830008	Chain Counter AA560R/C							•	•	•	•	•	•	•	•	•	•	•
68000602	Hand-Held Chain Counter							•	•	•	•	•	•	•	•	•	•	•
66830010	Chain Counter AA150							•	•	•	•	•	•	•	•	•	•	•
Wireless Remotes																		
68000844	3-Button Wireless Remote and Receiver			*	*	•	•	•	*	•	•	•	•	•	•	•	•	•
68000845	5-Button Windlass & Thruster Remote and Receiver			*	*	•	•	•	*	•	•	•	•	•	•	•	•	•

* See page 27 for more details

Switchgear Options - Single or dual-station operation available



Electric Deck Switch



Toggle Switch



Guarded Rocker Switch



Circuit Breaker to protect windlass from overload



Hand Held Control Switch



Chain Counters

Panel mount AutoAnchors. Suitable for DC electric windlasses using all-chain or rope/chain rode and hydraulic or AC powered windlasses using all-chain rode.

Features

- Works with prefitted reed switch sensors
- Has additional diagnostics to help troubleshoot installation
- Large LCD display shows at a glance how much anchor rode is out
- “One touch” automatic function deploys and retrieves a preset length of anchor rode
- Docking alarm and preset stopping point help protect the boat during anchor retrieval
- Adjustable red backlighting ensures clear night operation
- Choice of feet or meters rode measurement
- Safety lock reduces unwanted windlass operation
- Easy installation and setup
- Install up to 2 units or combine with the AA150 or AA560 for multiple stations on the boat
- Weather cover to protect the console unit
- Console color grey





6800846

68000847

Wireless RF Remote Control

Both the 3-Button Windlass Remote Kit and the 5-Button Windlass & Thruster Kit are easily retrofitted to existing installations and include a replaceable battery. The fobs float and are waterproof to IP67 (1 meter deep). Using over one billion individual codes, our proprietary encryption scheme prevents false triggering from any other device or similar fob. And both kits include a Receiver that supports up to eight remote key fobs (additional fobs sold separately).

3-Button Windlass Wireless Remote Kit

Part No. 68000844

- Allows wireless remote operation (Up/Down) of any Lewmar or Simpson Lawrence (solenoid switched) Windlass *
- FCC & CE
- Kit includes one wireless Fob and one Receiver

3-Button Spare Windlass Remote Fob Only

Part No. 68000846

Add 1 or more additional Handheld Remote Fob(s) to the 3-Button Windlass Wireless Remote Kit Above. Code setup of additional Fobs is quick and easy (requires access to the Receiver).

5-Button Windlass & Thruster Wireless Remote Kit

Part No. 68000845

- Allows wireless operation of any Lewmar Thruster (Port & Starboard Thrust) and any Lewmar or Simpson Lawrence (solenoid switched) windlass (Up/Down)*
- FCC & CE
- Kit includes one wireless Fob, 1 Windlass Receiver and 1 Thruster Receiver

5-Button Spare Windlass & Thruster Remote Fob Only

Part No. 68000847

Add 1 or more additional Handheld Remote Fob(s) to the 5-Button Windlass & Thruster Wireless Remote Kit Above. Code setup of additional Fobs is quick and easy (requires access to the Receiver)

* Some smaller Lewmar and Simpson Lawrence windlasses are not equipped with solenoids (also sometimes referred to as Control Boxes or Contactors). Generally, any Lewmar or Simpson Lawrence windlass with a Minimum Pull of at least 363kg (800lbs) is solenoid equipped (i.e. Pro-Series 1000, Pro-Fish 1000, V1 through V5, Concept 1 through 3, Horizon 900, Sprint Atlantic, Sprint 1000 through 3000, Horizon 900 and above, etc). Smaller windlasses without solenoids will require the addition of a dual-direction solenoid and rocker switch to use a Wireless Kit. If in doubt contact Lewmar or your Lewmar Retailer.

Replacement Receiver for either a Windlass or Thruster

Part No. 68000848

Works on a negative or positive solenoid switched Thruster or solenoid switched Windlass.

Distributor List



Argentina

North Sails Sud Argentina

Del Arca 59
1646 San Fernando, Buenos Aires - Argentina
tel: +54 11 4725 0200
fax: +54 11 4746 7561
web: www.northsailsusdamerica.com



Australia

Barlow Distributors (Australia) Pty Ltd

177 Phillip Street, Redfern NSW, 2016 Australia
tel: + 61 29 318 2128
email: barlow@hotmail.net.au

Harrold Marine Wholesale Pty Ltd

Unit 3/19 Success Street, Acacia Ridge, Brisbane, Queensland, 4110 Australia
tel: +61 73 277 6563
fax: +61 73 277 6567
email: hmw@optusnet.com.au

JPW (Aust) Pty Ltd

Unit 3, 51 Division Street
Welshpool, Western Australia, 6106 Australia
tel: +61 89 351 9266
fax: +61 89 351 9266
email: ghunter@jpwmarine.com.au



Austria

Alltechnik GmbH

Rheinboldtstrasse 11-13
A 2362 Biedermannsdorf
Bei Wien, Austria
tel: +43 2236 6467 60
fax: +43 2236 64676 76
email: office@allroundmarin.com
web: www.allroundmarin.com



Brazil

Sailing Products

Avenida das Americas, 500 BL 11/207 Downtown
Barra, CEP 22640-100
Rio De Janeiro, Brazil
tel: +55 2131549990
fax: +55 2124947223
email: sailing@sailing.com.br
web: www.sailing.com.br



Bulgaria

Yacht Shop Bulgaria (Transcommerce)

Passenger Terminal, 2 Floor
Port Varna, Bulgaria
tel: +359 52 69 22 99
email: info@LYyachting.com
web: www.LZyachting.com



Canada

Payne's Marine Group

2120 Quadra Street
Victoria, BC V8T 4B9, Canada
tel: +250 382 7722
fax: +250 382 4043
email: sales@paynesmarine.com
web: www.paynesmarine.com

Payne's Marine Group

2360 Industrial Street
Burlington, Ontario L7P 1A1, Canada
tel: +905 332 8291
fax: +905 332 0557
email: sales@paynesmarine.com
web: www.paynesmarine.com



Canary Islands

Rolnautic S.L.

Calla Cuzco No 8, El Cebadal
Las Pamas De Grand Canarias 35008, Canary Islands
tel: +34 928296811
fax: +34 9282300344
email: jcrodriguez@rolnautic.com



Chile

Winnacorp LTDA

Tobalaba 1781, Providencia, Santiago, Chile
tel: +011 56 221 26494
fax: +011 56 224 67168



Croatia

Maritima d.o.o.

Put Sepurine 1
22203 Rogoznica, Croatia
tel: +385 (0) 22 558 130
fax: +385 (0) 22 558 131
email: info@nautical-equipment.com
web: www.nautical-equipment.com



Czech Republic

Avar Yacht

Areal ZD Veverske Kninice
664 81 Ostrovacice, Czech Republic
tel: +420 546 428015
fax: +420 546 428075
email: yacht@avaryacht.cz
web: www.avaryacht.cz



Denmark

Selden Mast A/S

Bakkegardsvej 406
DK-3050 Humlebaek, Denmark
tel: +45 39 18 44 00
fax: +45 39 27 17 00
email: info@seldenmast.dk
web: www.seldenmast.dk



Finland

Oy Maritim

P.O. Box 46, Veneentekijäntie 1
Helsinki 210, Finland
tel: +358 (0)207 65180
fax: +358 (0)207 652942
email: maritim@maritim.fi
web: www.maritim.fi



France

Accastillage Bernard

880 Avenue St Exuperiey, 6210, Mandelieu, France
tel: +33 4 93 90 47 47
fax: +33 4 93 90 47 53
email: contact@accastillage-bernard.fr
web: www.accastillage-bernard.com

Technique Distribution

Z.A. De Kermaquer, 56470, La Trinité Sur Mer, France
tel: +33 297557256
fax: +33 297557258
email: contact@technique-greement.com



Germany

Lankhorst/Hohorst GmbH

Bonifatiusstrasse 411, D 48432 Rheine, Germany
tel: +49 59 719707
fax: +49 59 716064
email: info@lankhorst-hohorst.de
web: www.lankhorst-hohorst.de



Gibraltar

M Sheppard & Co Ltd

Waterport Wharf, PO Box 899, Gibraltar
tel: +350 75148
fax: +350 42535
email: admin@sheppard.gi
web: www.sheppard.gi



Greece

Nautilus Ltd

Posidonos Av 33/, Metamorfoseos Str 2, Alimos
Athens 17455, Greece
tel: +30 210 9854238
fax: +30 210 9849 444
email: info@nautilus.gr
web: www.nautilus.gr



Hong Kong

Piercey Marine

93 Che Keng Tuk Road, Sai Kung, Hong Kong
tel: +(852) 27914106
fax: +(852) 27914124
email: pmltd@netnavigator.com



Hungary

Hullam 04 KFT

8220 Balatonalmadi, Füzfői ut 9, Hungary
Tel +36 88 432 897
Fax +36 88 432 897
info@fukeyacht.hu
www.fukeyacht.hu



Ireland

Western Marine

Bulloch Harbour, Dalkey
Co Dublin, Ireland
tel: +353 01 2800321
fax: +353 01 2800327
email: marine@iol.ie

Distributor List



Israel

Atlantis Marine Ltd

147, Kikar Atarim, 169 Hayarkon Street
Tel Aviv, 63453, Israel
tel: +972 3 522 7978
fax: +972 3 523 5150
email: atlantis@inter.net.il
web: www.atlantis-marine.co.il



Italy

Osculati Spa

via Pacinotti, 12
20090 Segrate (Milano), Italy
tel: +39 02 2699 111
fax: +39 02 26991120
email: info@osculati.it
web: www.osculati.com



Japan

ISCO/Industrial Suppliers Co Ltd SA

NAC Minato Building 2F
2-1-24 Kaigan, Minato-ku, Tokyo, 105-0022, Japan
tel: +81 3 5443 8231/8234
fax: +81 3 5443 8240/8241
email: sales@isco.co.jp
web: www.isco.co.jp

Nakamura Sengu Kogyo Co Ltd

6-15 Nagata-Higashi 3 Chome
Minami-Ku, Yokohama, 232, Japan
tel: +81 4 5713 5481
fax: +81 4 5713 8373
email: nakasen@marinevance.com



Kuwait

Seas & Deserts

Amiry Trade Centre, Shuwaikh Bank Street
PO Box 110, Safat 13002, Kuwait
tel: +965 4 849 212
fax: +965 4 845 346
email: sales@seadesert.com
web: www.seadesert.com



Malta

Gauci Borda & Co Ltd

53 Msida Road, Gzira, GZR 03, Malta
tel: +356 21313758
fax: +356 2134 3604
email: info@gauciborda.com
web: www.gauciborda.com



Martinique

Caraibes Greement

Boulevard Allegre
97290 Le Marin, Martinique
tel: +596 74 80 33
fax: +596 74 66 98
email: cgmar@wanadoo.fr



Netherlands

Lankhorst Taselaar Bv

Binnenhavenweg 31. 8211 AA
Lelystad, Netherlands
tel: +31 320 274611
fax: +31 320 231912
email: info@lankhorst-taselaar.nl
web: www.lankhorsttaselaar.nl



New Zealand

Kiwi Yachting Consultants Ltd

15 Westmoreland St West, Grey Lynn
Auckland, New Zealand
tel: +64 (0)9 360 0300
fax: +64 (0)9 360 0302
email: sales@kiwiyachting.co.nz
web: www.kiwiyachting.co.NZ



Norway

Leif H Strom A/S

Hasleveien 15, N-0571, Oslo, Norway
tel: +47 23 23 39 70
fax: +47 23 23 39 71
email: mail@stroem.no
web: www.stroem.No



Poland

Aura

Ul Przechodnia 13, 70-800 Szczecin, Poland
tel: +48 91 4613992
fax: +48 91 4613741
email: michal@aura.szczecin.pl
web: www.aura.szczecin.pl



Portugal

Grupo Euronete

Lugar do Rio, Nogueira da Maia
PO Box 1029, 4471-909 Maia, Portugal
tel: +351 229619200
fax: +351 229605757



Russia

000 Moreman

19, building 2
Gamalei street Moscow, 123098, Russia
tel: +7 495 1013362
fax: +7 499 1937111
email: info@moreman.ru
web: www.moreman.ru



Singapore

Alquest Marketing

66, Tannery Lane, #02-06B Sindo Building
347805, Singapore
tel: +65 6749 9359
fax: +65 6749 9360
email: jason@alquest.com.sg
web: www.alquest.com.sg



Slovenia

Seawave Marine D.O.O

Alpska Cesta 0043, 4248 Lesce, Slovenia
tel: +386 (0)4 5302 444
fax: +386 (0)4 5302 440
email: info@seawave-marine.si
web: www.seawave-marine.si



South Africa

Central Boating

85 Bree Street
Cape Town, 8001, South Africa
tel: +27 21 424 8026
fax: +27 21 424 2564
email: info@centralboating.co.za
web: www.centralboating.co.za



Spain

Acastillaje Synera SL

Passeig Joan de Borbós, 92, 08039
Barcelona, Spain
tel: +34 93 225 49 34
fax: +34 93 225 19 49
email: info@sinerarigging.com
web: www.sinerarigging.com



Sweden

Navship AB

Box 37, SE-427 21 Billdal, Sweden
tel: +46 31 93 96 00
fax: +46 31 91 45 56
email: info@navship.se
web: www.navship.se



Switzerland

Bucher + Walt SA

Route de Soleure 8, CH 2072 St Blaise, Switzerland
tel: +41 327 559500
fax: +41 327 559530
email: info@bucher-walt.ch
web: www.bucher-walt.ch



Taiwan

Marineware

2fl, No.172, Section 1 Ling Mi Road, Pali Shiang 249,
Taipei County, Taiwan
tel: +886 22618 8342



Thailand

Phuketsail

3/2-4 Moo 5, Koh Keaw, Phuket City,
Phuket, 83200, Thailand
tel: +66 76 377542
fax: +66 76 238494
email: ecommerce@phuleksail.com
web: www.phuketsail.com

Distributor List



Turkey

Kaptan Denizcilik Ticaret A.S.

Ahmet Mithat Efendi Cad 13/1,81030 Kalamis
Istanbul, Turkey

tel: +90 216 337 2000
fax: +90 216 348 2999
email: info@kaptandenizcilik.com
web: www.kaptandenizcilik.com



United Arab Emirates

Delma Industrial Supply & Marine Service

P.O. Box 53382

Abu Dhabi, UAE

tel: +971 2 6668153
fax: +971 2 6668154
email: disms@emirates.net.ae

Duboats Trading Llc

PO Box 53793

City Tower 2 Sheikh Zayed Road,
10th Floor, Office 1002

Dubai, UAE

tel: +971 04 332 7771
fax: +971 04 332 2456
email: c.vanek@duboats.com



United Kingdom

Bainbridge International Ltd

8 Flanders Park, Hedge End
Southampton, Hampshire, SO30 2FZ

tel: +44 (0)1489 776000
fax: +44 (0)1489 776048
email: info@bainbridgeint.co.uk
web: www.bainbridgeint.com

Whitlock South

17 Hollybank Lane,
Emsworth Hants, PO10 7UD

tel: +44 (0) 1243 430050
email: enquiries@winchservicing.com
web: www.winchservicing.com



USA

Lewmar

351 New Whitfield Street, Guilford, CT, 06437, USA

tel: +1 203 458 6200
fax: +1 203 453 5669
email: info@lewmarusa.com

For a complete list US distributors please visit:

<http://www.lewmar.com/usa/distributors.htm>



Venezuela

Intermarine

AV Intecomunal De Guatire

Cruse Con C, La Arenera, Venezuela

tel: +58 0212 344 16 77
fax: +58 0212 344 14 23
web: www.intermarine.com.ve

Caribbean

Antigua Rigging

Falmouth Harbor, Antigua

tel: +268 562 1294
fax: +268 463 8575
email: info@antiguarigging.com
web: www.antiguarigging.com

Budget Marine

Western Main Road, Chaguaramas, Trinidad

tel: +1 904-477-8011
email: sales@budmar.an
web: www.budmar.an

Caraibes Greement

2 Porte de la Marina, 97110 Pointe A Pitre

Guadeloupe, Guadeloupe

tel: +590 908201
fax: +590 909750
email: caraibe.greement@wanadoo.fr

FKG Marine Rigging & Fabrication NV

Postal Address: PO Box 5011, Philipsburg, St Maarten

Physical Address: 37 Wellington Road, Cole Bay,
St. Maarten, Netherlands Antille

tel: +599 544 4733
mobile: +599 557 8502
fax: +599 544 2171
email: info@fkg-marine-rigging.com
web: www.fkg-marine-rigging.com

Island Rigging and Hydraulics

8186 Sub Base Road, Suite 4

St. Thomas, USVI, 00802

tel: 011-340-774-6833
fax: 011-340-774-5024
email: islrig@viaccess.net

Martinez Marine Service

Puerto del Rey Marina Suite #103

Highway #3, Km 51.4

Fajardo, PR, 00738

tel: (787) 863-4646
fax: (787) 272-8172
web: www.martinezmachine.com



665641197-102	9	66910088-143	17	68000593	25	89100078	205	89400034	194	89600383	231	89700298	186
665641198-102	9	66910089-143	17	68000595	25	89100079	205	89400035	194	89600384	231	89700299	186
665681196-303	5	66910090-144	17	68000596	25	89100080	205	89400036	194	89600385	231	89700300	186
665681197-303	5	66910091-144	17	68000599	25	89100090	205	89400045	195	89600386	231	89700301	186
665701108-102	7	66910092-144	17	68000602	25	89100091	205	89400046	195	89600387	231	89700302	186
6657011196-102	7	66910093-144	17	68000603	25	89100092	205	89400047	195	89600388	231	89700308	186
6657011197-102	7	66910094-146	17	68000604	25	89100093	205	89400048	193	89600389	231	89700309	186
6657011198-102	7	66910095-146	17	68000627	25	89100094	205	89400084	194	89600453-89600462	232	89700310	186
667001107	13	66910100-146	17	68000628	25	89100095	205	89400100	196	89600463-89600472	232	89700311	186
6670011196	13	66910101-146	17	68000840	15	89100096	205	89400109	193	89600473-89600482	232	89700312	186
6670011197	13	66910106-146	17	68000844	25	89100098	207	89400109	194	89600483-89600492	232	89700313	186
667101107-138	15	66910107-146	17	68000845	25	89100099	207	89400117	193	89600493-89600502	232	89700344	188
667101108-138	15	66910108-146	17	68000845	25	89100100	207	89400118	198	89600503-89600512	232	89700345	188
6671011196-138	15	66910109-146	17	68000847	27	89100111	209	89400120	194	89600513-89600522	232	89700346	188
6671011197-138	15	66910200	23	68000846	27	89100112	209	89400122	194	89600523-89600532	232	89700347	188
6671011198-138	15	66910201	23	69000331	31	89100113	209	89400123	194	89600533-89600542	232	89700348	188
6671011698-138	15	66910202	23	69000332	31	89100114	209	89400125	194	89600543-89600552	232	89700354	188
6671011697-138	15	66910203	23	69000333	31	89100115	209	89400133	193	89600553	232	89700355	188
6671011698-138	15	68000015	20	69000334	31	89100116	205	89400136	193	89601000	230	89700356	188
6672011108-138	15	68000016	20	69000335	31	8910143	185	89400137	193	89601001	230	89700357	188
6672012108-138	15	68000017	21	69000336	31	89100143	186	89400146	193	89601002	230	89700358	188
6672011110-138	15	68000017	20	69000337	31	89100144	186	89400192	198	89601003	230	89700375	185
6672022110-138	15	68000023	19	69000338	31	89100144	187	89400196	193	89601004	230	89700376	185
6672011196-138	15	68000024	19	69000339	31	89100160	223	89400200	197	89601005	230	89700377	185
6672021196-138	15	68000027	21	69000340	31	89100196	208	89400203	197	89601006-89601015	231	89700383	187
6672011197-138	15	68000037	19	69000341	31	89100401	205	89400204	197	89601016-89601025	231	89700406	185
6672021197-138	15	68000043	21	69000342	31	89100403	205	89400205	197	89601026-89601035	231	89700407	185
6672011198-138	15	68000049	20	69000343	31	89100405	205	89400206	197	89601036-89601045	231	89700408	185
6672011198-138	15	68000094	22	69000344	31	89100407	205	89400218	196	89601046-89601055	231	89700410	187
6672012108-140	15	68000099	21	69000345	92	89100409	205	89400222	197	89601077-89601086	232	89700411	187
6672022108-140	15	68000099	22	69000346	92	89100411	205	89400223	197	89601087-89601096	232	89700412	187
6672012110-140	15	68000112	22	69000346	95	89100413	205	89400224	197	89601097-89601106	232	89700413	187
6672022110-140	15	68000113	22	69000350	92	89100415	205	89400274	197	89601107-89601116	232	89700414	187
6672011196-140	15	68000114	21	69000373	92	89100569	208	89400283	198	89601117-89601126	232	89700415	187
6672022196-140	15	68000115	21	69600533	10	89100750	206	89400284	198	89601127-89601136	232	89700416	187
6672012197-140	15	68000116	22	69600534	10	89200032	220	89400285	198	89601137-89601146	232	89700417	187
6672022197-140	15	68000117	22	69600535	10	89200034	219	89400286	198	89601147-89601156	232	89700431	186
6672012198-140	15	68000123	22	69600536	10	89200035	219	89400291	199	89601157-89601166	232	89700432	186
6672022198-140	15	68000129	25	69600537	10	89200037	220	89400298	194	89601167-89601176	232	89700451	187
6672211108-139	15	68000130	25	69600538	10	89200040	219	89400299	194	89601177	232	89700520	185
667221108-139	15	68000164	22	69600539	10	89200041	220	89400300	194	89700011	186	89700521	185
6672211110-139	15	68000173	21	69600540	10	89200046	220	89400327	188	89700012	186	89700571	187
6672211110-139	15	68000173	22	69600541	10	89200048	221	89400328	197	89700024	186	89700581	187
6672211196-139	15	68000174	21	69600542	10	89200048	220	89400329	196	89700025	186	89700591	187
6672211196-139	15	68000174	22	69600543	10	89200050	221	89400330	196	89700037	186	89700601	187
6672211197-139	15	68000211	22	69600544	10	89200050	220	89400355	196	89700038	186	89700602	187
6672211197-139	15	68000217	22	69600545	10	89200052	221	89400356	196	89700050	186	89700603	187
6672211198-139	15	68000239	92	69600546	10	89200057	217	89400361	195	89700051	186	89700604	187
6672211198-139	15	68000240	25	69600547	10	89201637	195	89400362	195	89700052	186	89700605	187
6672212108-142	15	68000278	22	69600548	10	89300000	227	89400363	195	89700064	186	89700607	187
667222108-142	15	68000294	24	69600556	23	89300002	227	89400365	198	89700076	186	89700646	186
6672212110-142	15	68000294	17	69600557	23	89300003	223	89400371	197	89700077	186	89800108	187
6672222110-142	15	68000295	22	69000597	25	89300004	227	89400372	197	89700078	186	89900010	190
6672212196-142	15	68000296	22	82000598	25	89300008	227	89400409	198	89700079	186	89900011	190
6672222196-142	15	68000318	25	82000356	214	89300010	227	89400410	198	89700080	186	89900012	190
6672212197-142	15	68000319	25	82000357	214	89300016	225	89500002	214	89700081	186	89900013	193
6672222197-142	15	68000320	25	823GPST	106	89300017	225	89500008	214	89700082	186	89900014	191
6672212198-142	15	68000321	25	89000004	214	89300029	225	89500011	214	89700083	186	89900015	191
6672222198-142	15	68000325	22	89100000	204	89300039	223	89500012	214	89700084	186	89900016	191
66810011	23	68000326	22	89100001	204	89300039	226	89500013	214	89700085	186	89900098	187
66810011	16	68000348	25	89100002	204	89300040	223	89500014	214	89700086	186	89900222	191
66810012	23	68000349	92	89100003	204	89300041	226	89500497	223	89700087	186	89900223	191
66810012	16	68000349	25	89100004	204	89300045	226	89600040-89600049	231	89700088	186	89900224	191
66810024	16	68000350	92	89100006	204	89300049	226	89600050-89600059	231	89700089	186	89900303	190
66810025	16	68000350	25	89100008	204	89300051	223	89600060-89600069	231	89700090	186	89900304	191
66810031	17	68000351	92	89100010	204	89300053	223	89600070-89600079	231	89700091	186	89900307	191
66810032	23	68000351	25	89100015	206	89300053	225	89600080-89600089	231	89700092	186	89900343	191
66830008	26	68000356	17	89100016	206	89300054	225	89600090-89600099	231	89700093	186	89900350	191
66830008	25	68000357	17	89100018	206	89300054	223	89600100-89600109	231	89700094	186	89900352	191
66830008	25	68000358	17	89100019	206	89300055	225	89600110-89600119	230	89700095	186	89900356	191
66830010	26	68000359	17	89100022	206	89300057	223	89600120-89600129	230	89700096	186	89900357	191
66830010	25	68000360	15	89100023	206	89300060	225	89600130-89600139	230	89700097	186	89900198	192
66840003	17	68000361	15	89100024	206	89300060	21	89600140-89600149	230	89700098	186	89900199	192
66840005	17	68000362	15	89100025	206	89300060	223	89600150-89600159	230	89700125	188	89900200	192
66840007	32	68000363	15	89100026	206	89300061	225	89600160-89600169	230	89700126	188	89900202	192
66840008	32	68000368	22	89100027	206	89300064	227	89600166-89600175	231	89700137	188	89900203	192
66840009	32	68000425	22	89100029	206	89300070	158	89600170-89600179	230	89700138	188	89900204	192
66840010	32	68000463	21	89100029	206	89300099	223	89600170-89600179	230				

Limited Warranty and Key Terms of Supply by Lewmar

Lewmar warrants that in normal private pleasure boat usage and with proper maintenance its products will conform with their specification for a period of three years from the date of purchase by the end user, subject to the conditions, limitations and exceptions listed below. Any product, which proves to be defective in normal usage during that three-year period, will be repaired or, at Lewmar's option, replaced by Lewmar.

A CONDITIONS AND LIMITATIONS

- i Lewmar's liability shall be limited to the repair or replacement of any parts of the product which are defective in materials or workmanship.
- ii Responsibility for the selection of products appropriate for the use intended by the Buyer shall rest solely with the Buyer and Lewmar accepts no responsibility for any such selection.
- iii Lewmar shall not be liable in any way for Product failure, or any resulting loss or damage that arises from:
 - a. use of a product in an application for which it was not designed or intended;
 - b. corrosion, ultra violet degradation or wear and tear;
 - c. a failure to service or maintain the product in accordance with Lewmar's recommendations;
 - d. faulty or deficient installation of the product (unless conducted by Lewmar);
 - e. any modification or alteration of the product;
 - f. conditions that exceed the product's performance specifications or safe working loads.
 - g. Abuse
- iv Product subject to a warranty claim must be returned to the Lewmar outlet that supplied the product for examination unless otherwise approved by Lewmar in writing.
- v This warranty does not cover any incidental costs incurred for the investigation, removal, carriage, transport or installation of product.
- vi Service by anyone other than authorized Lewmar representatives shall void this warranty unless it accords with Lewmar guidelines and standards of workmanship.

vii Lewmar's products are intended for use only in the marine environment. Buyers intending to use them for any other purpose should seek independent professional advice as to their suitability. Lewmar accepts no liability arising from such other use.

B EXCEPTIONS

Cover under this Warranty is limited to a period of one year from the date of purchase by the end user in the case of any of the following products or parts of products:

- Electric motors and associated electrical equipment
- Electronic controls
- Hydraulic pumps, valves and actuators
- Hatch & Portlight weather seals
- Products used in "Grand Prix" racing applications
- Products used in commercial or charter applications
- Anchor rodes

C LIABILITY

- i Lewmar's liability under this warranty shall be to the exclusion of all other warranties or liabilities (to the extent permitted by law). In particular (but without limitation):
 - a. Lewmar shall not be liable for:
 - Any loss of anticipated turnover or profit or indirect, consequential or economic loss;
 - Damages, costs or expenses payable to any third party;
 - Any damage to yachts or equipment;
 - Death or personal Injury (unless caused by Lewmar's negligence).

Some states and countries do not allow the exclusion or limitation of incidental or consequential damages, so the above limitation or exclusion may not apply to you.

- b. Lewmar grants no other warranties regarding the fitness for purpose, use, nature or satisfactory quality of the products.
- ii Where applicable law does not permit a statutory or implied warranty to be excluded, then such warranty, if permitted by that state or country's law, shall be limited to a period of one year from

the date of purchase by the end user. Some states and countries do not allow limitations on how long an implied warranty lasts, so this limitation may not apply to you.

D PROCEDURE

Notice of a claim for service under this warranty shall be made promptly and in writing by the end user to the Lewmar outlet that supplied the product or to Lewmar Limited at Southmoor Lane, Havant, Hampshire PO9 1JJ, England.

E SEVERANCE CLAUSE

If any clause of this warranty is held by any court or other competent authority to be invalid or unenforceable in whole or in part, the validity of the remaining clauses of this warranty and the remainder of the clause in question shall not be affected.

F OTHER RIGHTS

This warranty gives you specific legal rights, and you may also have other legal rights, which vary from state to state and country to country.

In the case of European States a Consumer customer (as defined nationally) has legal rights under the applicable national law governing the sale of Consumer Goods; this Warranty does not affect those rights.

G LAW

This warranty shall be governed by and read in accordance with the laws of England or the state or country in which the first end user is domiciled at the time of purchase of the product.

H DISPUTES

Any dispute arising under this warranty may, at the option of the end-user, be referred to alternative dispute resolution under the rules of the British Marine Federation or to the Courts of the State whose law shall govern the warranty or to the Courts of England and Wales.

The British Marine Federation may be contacted at Marine House, Thorpe Lea Road, Egham, England, TW20 8BF

UK & International Distribution

Lewmar
Southmoor Lane
Havant
Hampshire
PO9 1JJ
England

Tel: +44 (0)23 9247 1841
Fax: +44 (0)23 9248 5720
Email: info@lewmar.com

USA

Lewmar
351 New Whitfield Street
Guilford, CT
06437
USA

Tel: +1 203 458 6200
Fax: +1 203 453 5669
Email: info@lewmar.com

Northern Europe

Lewmar
Popovstraat 12
8013 RK
Zwolle
Netherlands

Tel: +31 (0)38 427 34 90
Fax: +31 (0)38 421 56 42
Email: info@holland.lewmar.com

Southern Europe

Lewmar
18 rue Leonard de Vinci
Z.A.C. Belle Aire Nord
17440 AYTRE
France

Tel: +33 5 46 50 50 46
Fax: +33 5 46 50 59 04
Email: info@lewmar.com

Australia/Asia

Lewmar Navtec Australasia Pty. Ltd.
6/224 Headland Rd.
Dee Why
New South Wales
2099
Australia

Tel: +61 (2) 9936 7111
Fax: +61 (2) 9936 7112
Email: info@lewmar.com.au

LEWMAR®

www.lewmar.com

© Copyright 2007 Lewmar Ltd. All rights reserved.



B10402